

MEIO

AMBIENTE



Manter a vida verde da cidade,  
e aumentar as áreas verdes,  
incentivar as pessoas a manter  
a vida verde em suas casas,  
aumentando áreas como jardins,  
etc

"LOW"  
Line BH



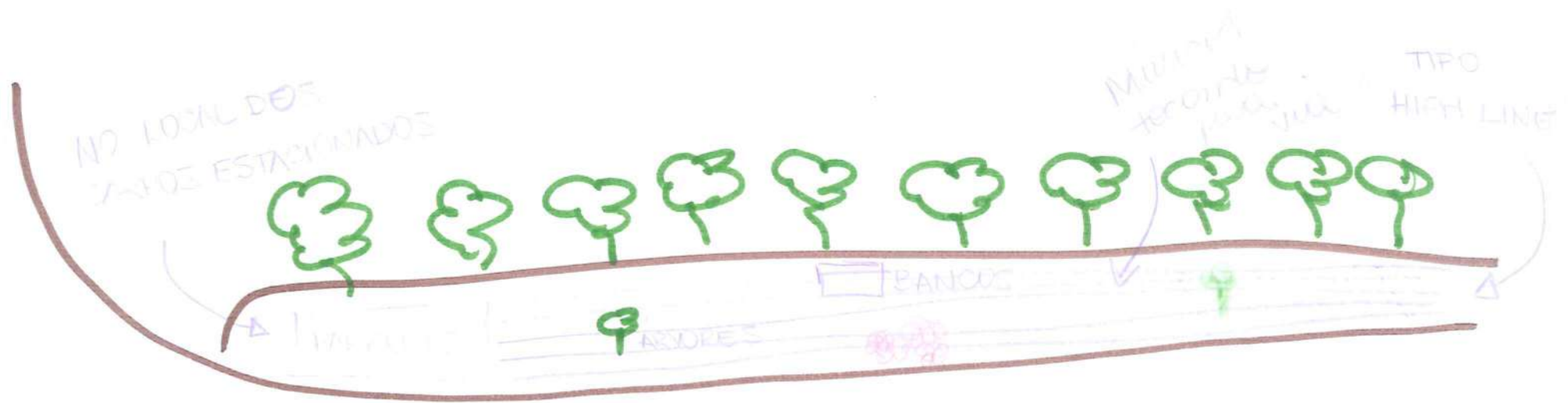

- - R. SAPUCAÍ - - - - -

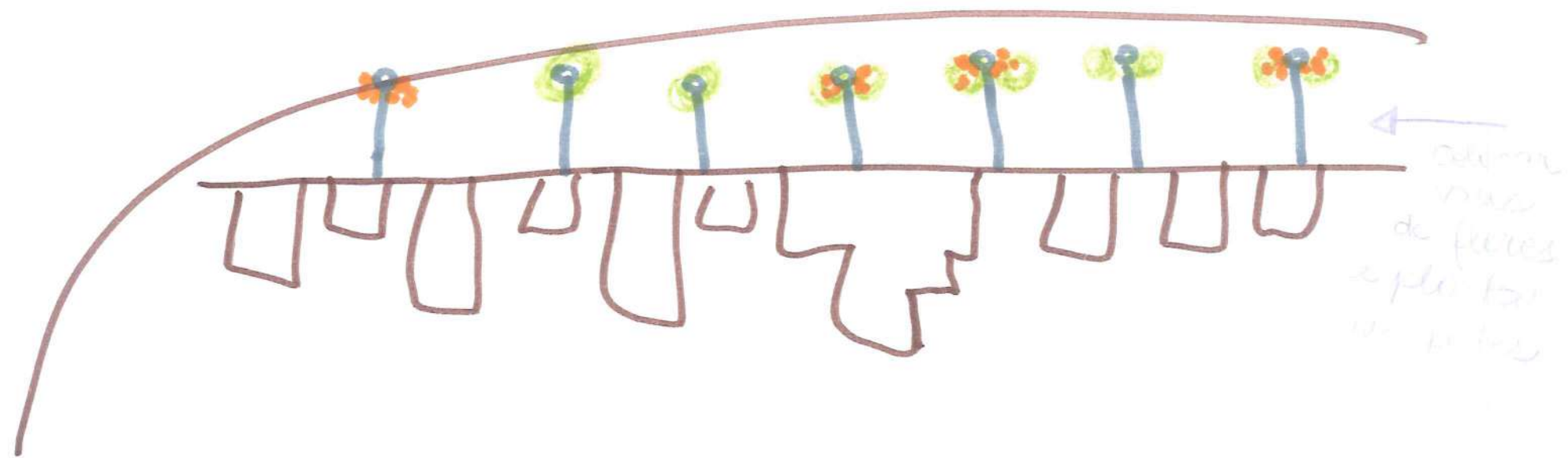



ÁRVORES FRUTÍFERAS  
NAS CALÇADAS....

*Luise Suron*  
Luise Suron

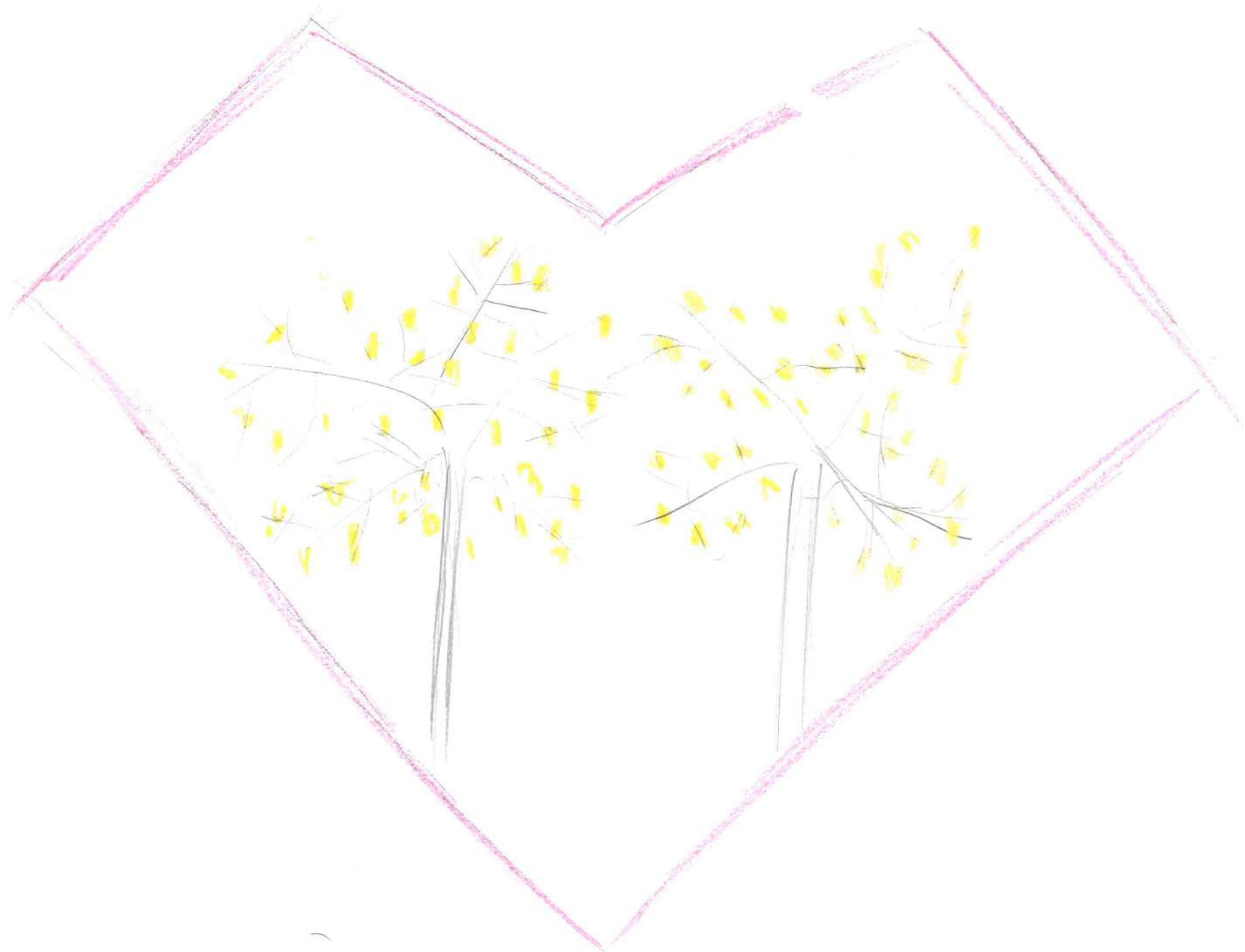



Cowboy Ranch



PRAÇA  
RIO  
BRANCO

AGUA TRATADA





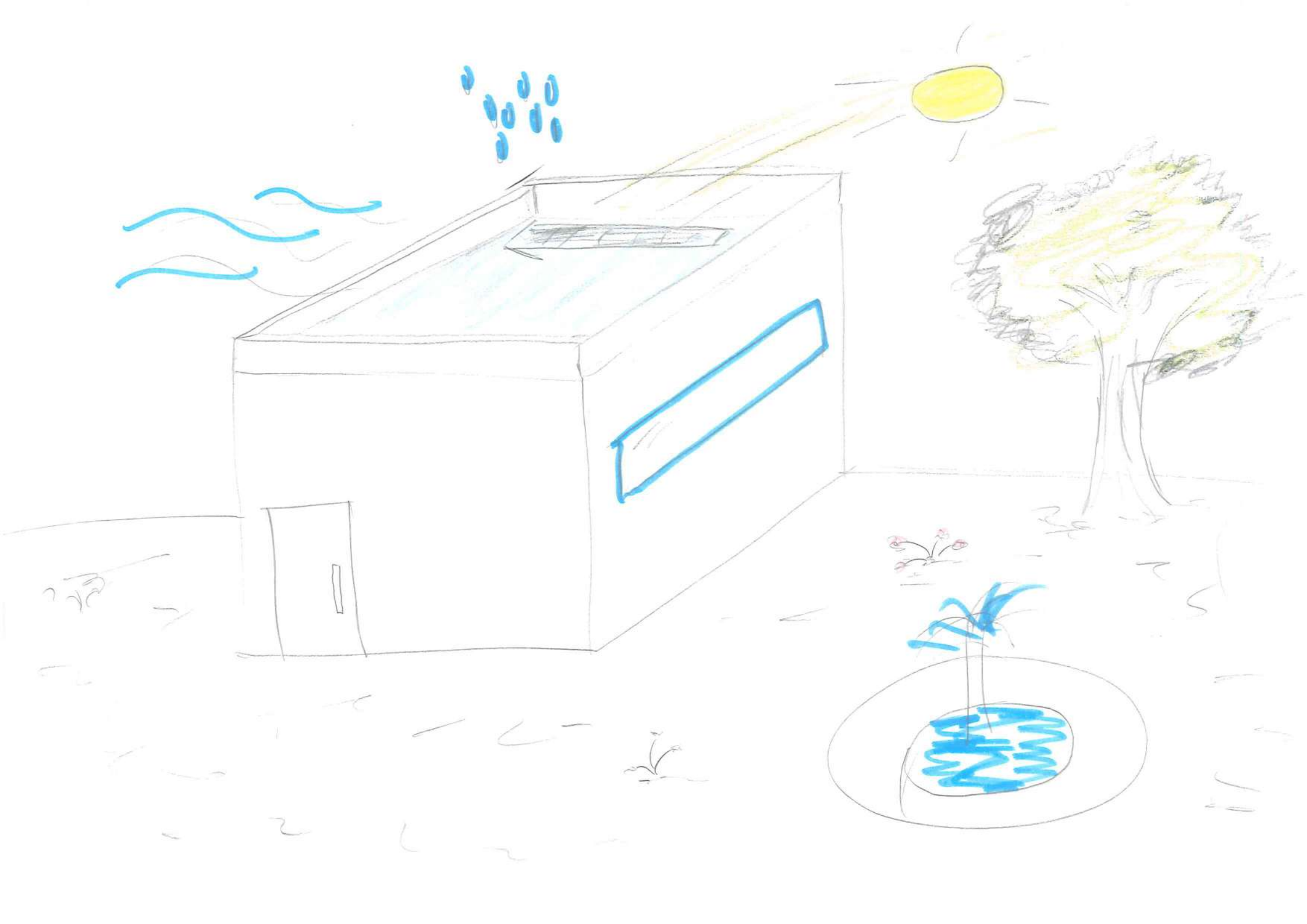

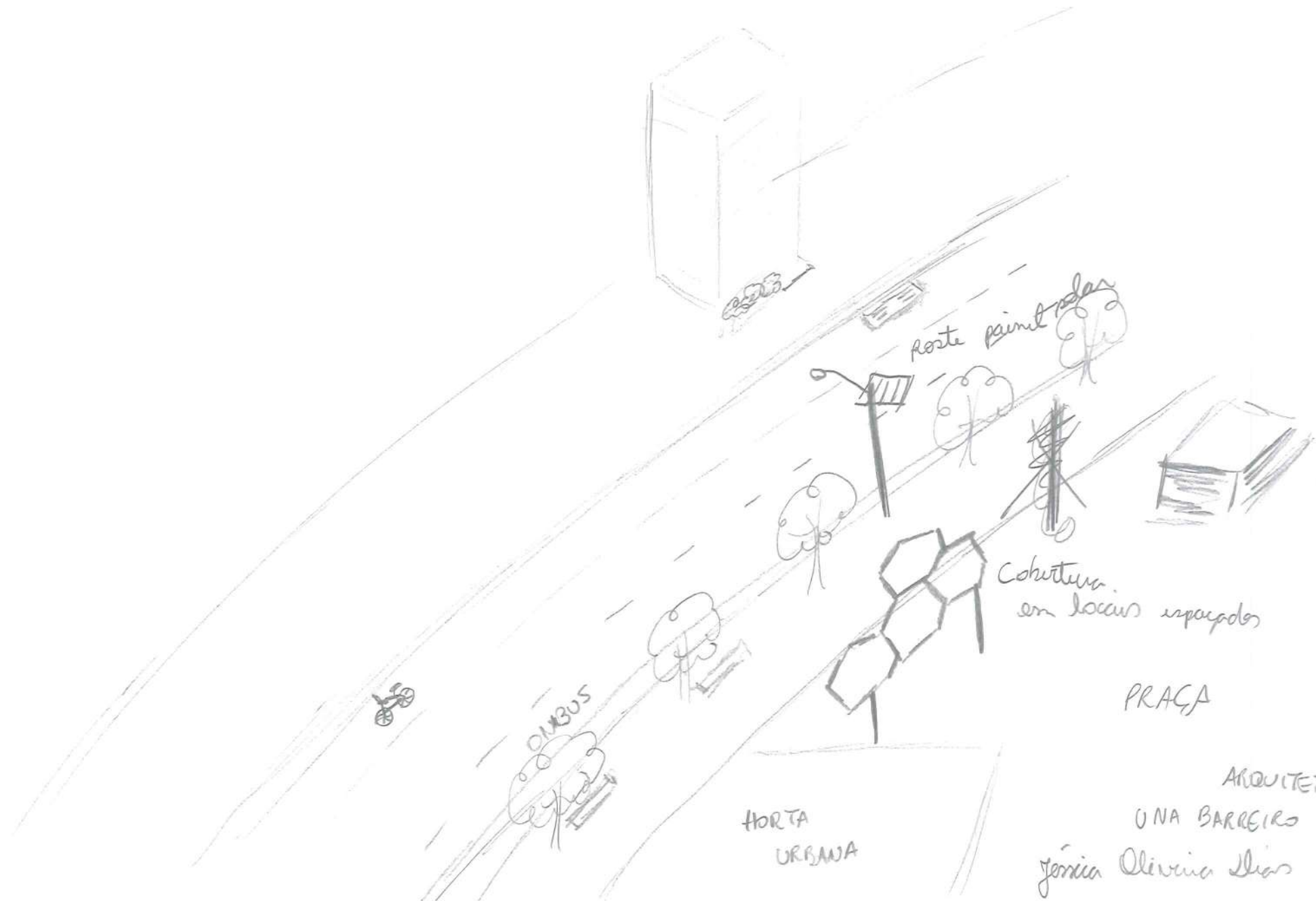

Roteirinho

Cobertura em locais espaçados

PRAÇA

HORTA URBANA

ARQUITETA

JÂNICA OLIVEIRA DIAS

JÂNICA OLIVEIRA DIAS

# CENTRO B.H.

MAIS VERDE



PONTOS DE CULINÁRIA NOS FINAIS DE SEMANA

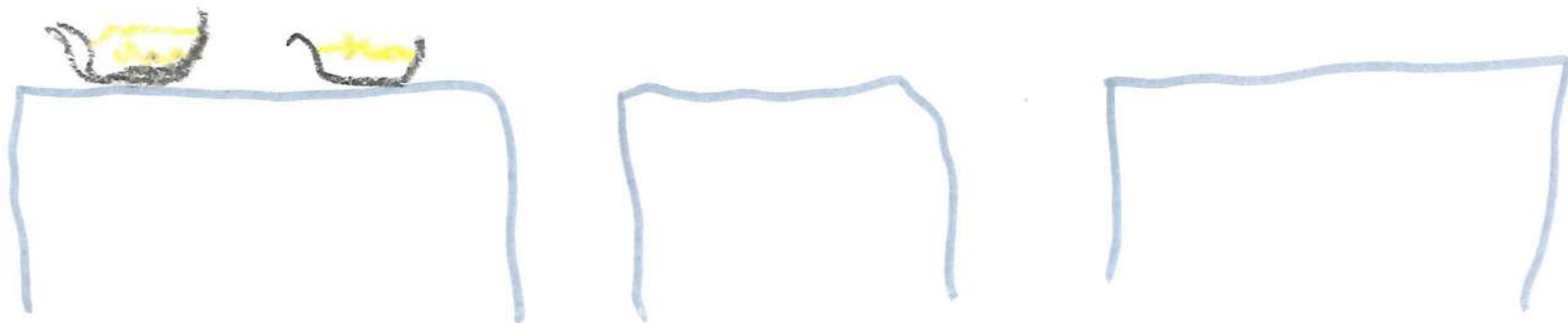

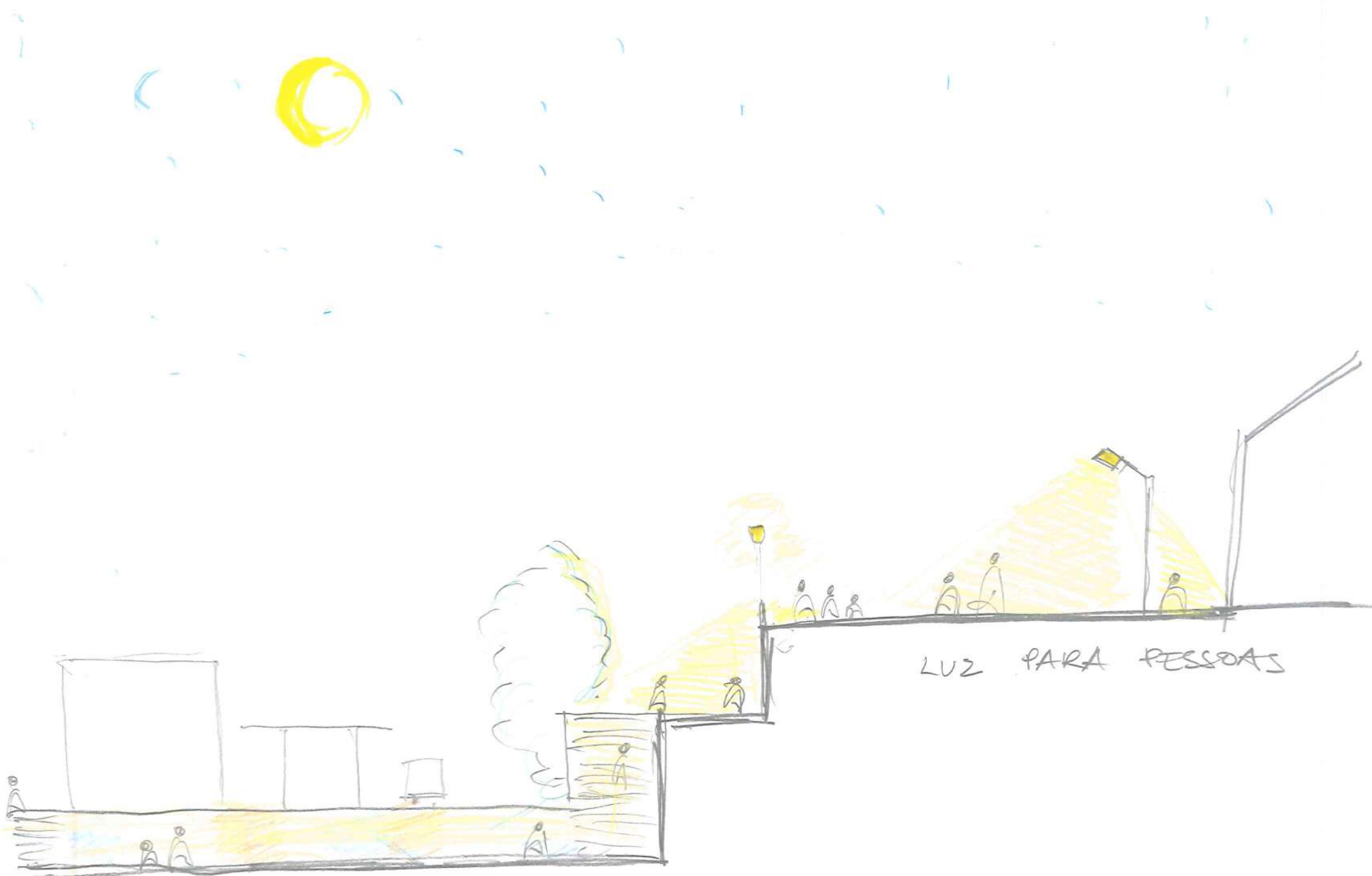

COR E LUZ PARA O  
TUNEL DE PEDESTRES

LUZ PARA PESSOAS



Clara

EDIFÍCIOS  
COM TETO VERDE

CENTRO VERDE  
PARQUE LINEAR EM TODO O CENTRO

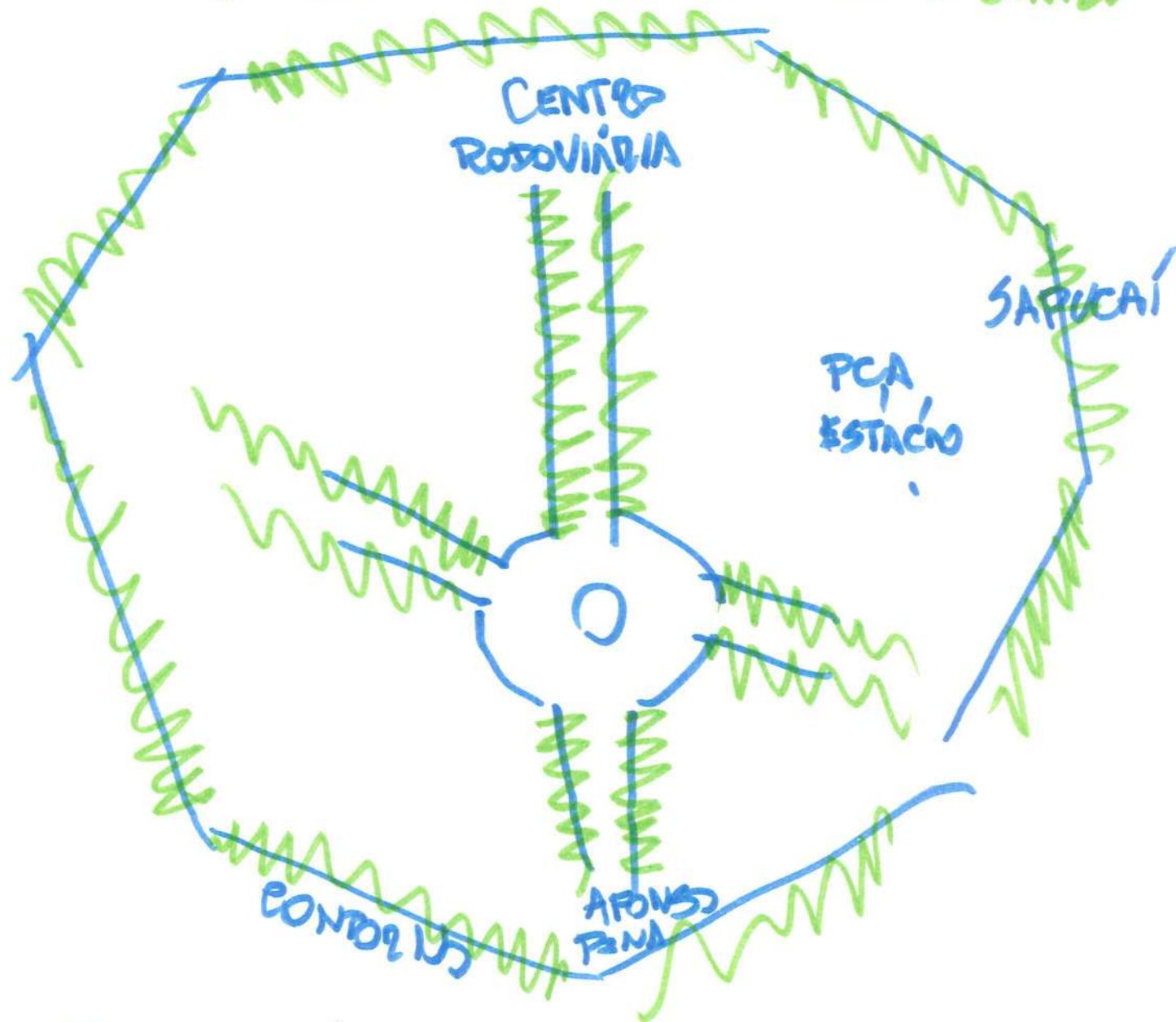

RUAS P/ PEDESTRES

O ABRAÇO  
DA SERRA  
DO  
CURRAL



100



Placa Solar

Placa Solar

Lixo

Lixo

Iluminação Solar  
nos Postes





Rua Sapucaí

Rua Sapucaí

Isabel Vaz  
Giseli Santos

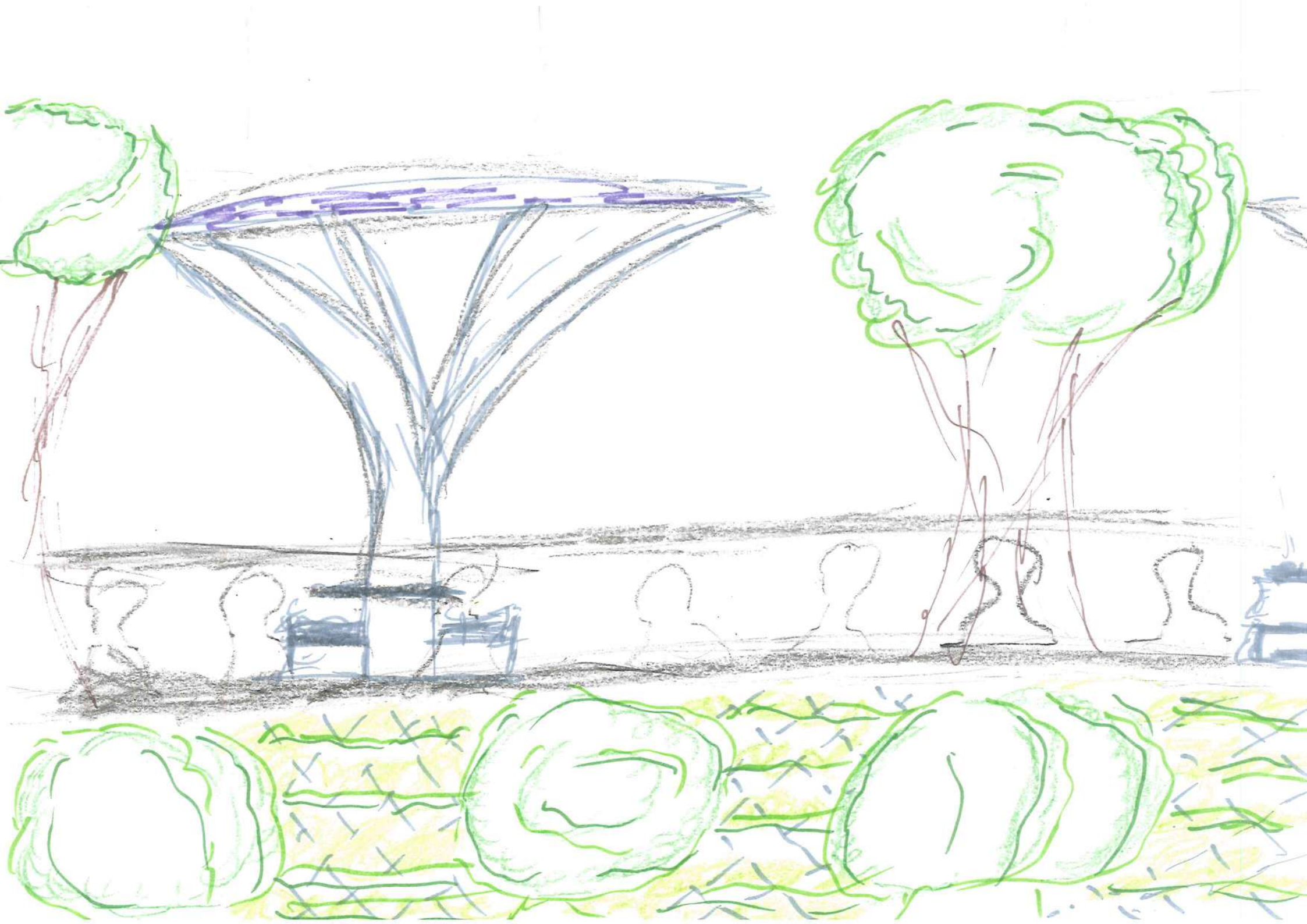

Área de  
preservação

Construções:  
museus  
universidades  
jardim botânico

Biomos  
naturais



Homagem  
as culturas

Sustentabilidade



Prédio verde  
fachim Vertical

Kabine Alcantara fachim  
UNA BARREIRO

criar pontos  
estratégicos  
reciclagem

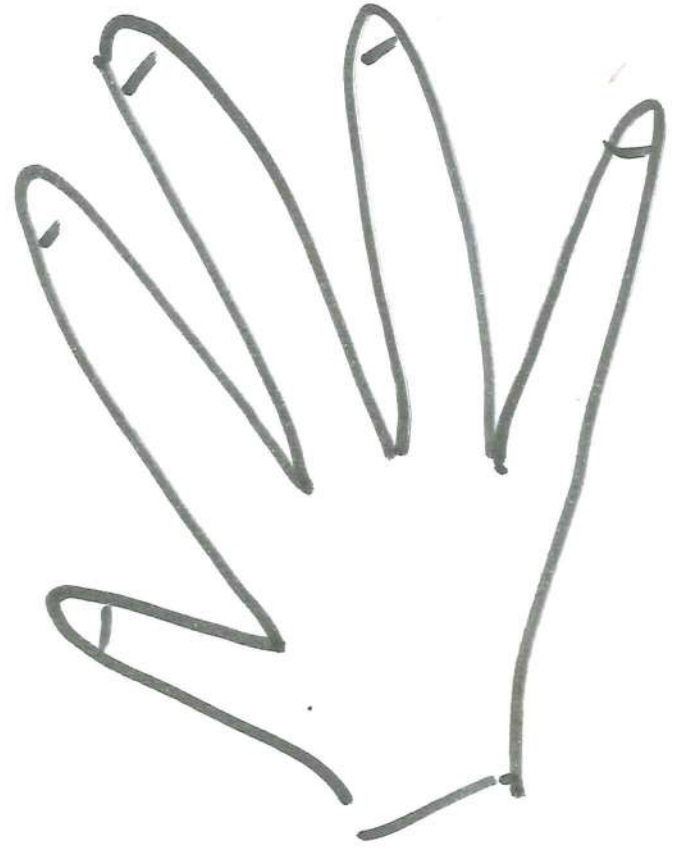
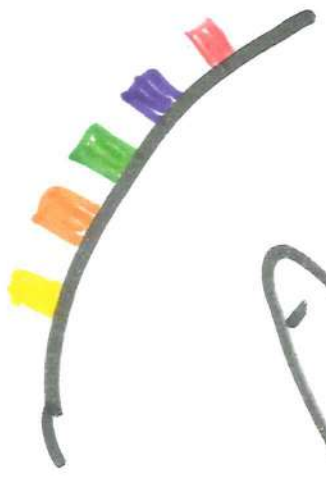

educar  
novos  
formatos  
com  
elementos  
de  
força  
e  
crianças  
em  
um  
novo  
formato  
com  
elementos  
de  
força

criar mais  
pontos verdes  
PI maior  
inclusão  
e  
sociali-  
zadas



trazer  
shows  
de  
qualidade  
em  
espaços  
públicos

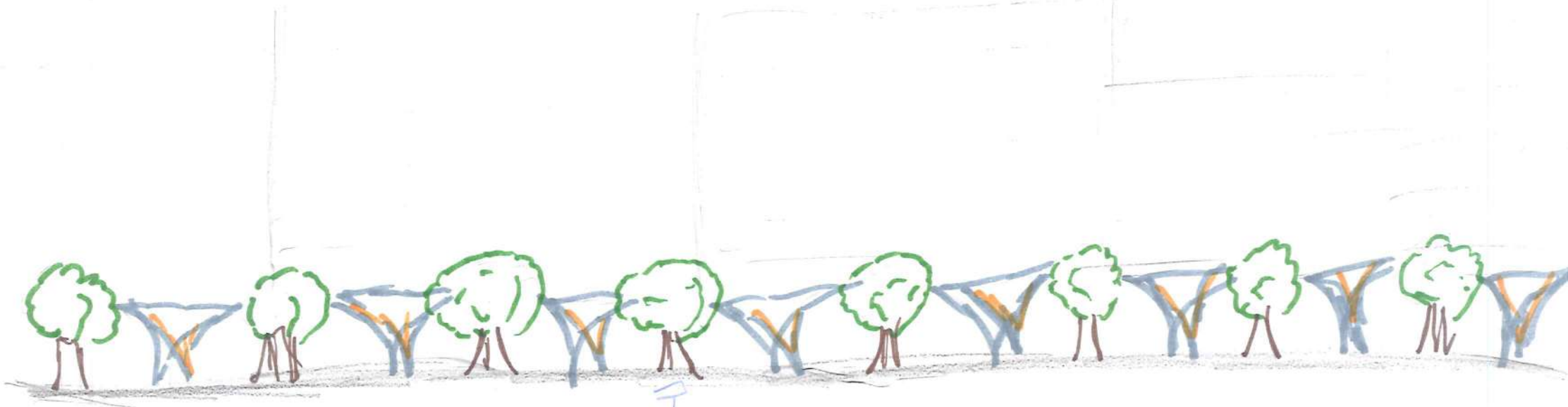

AGROSOLÉ captor de água térmica / Fotovoltaica  
4 braços

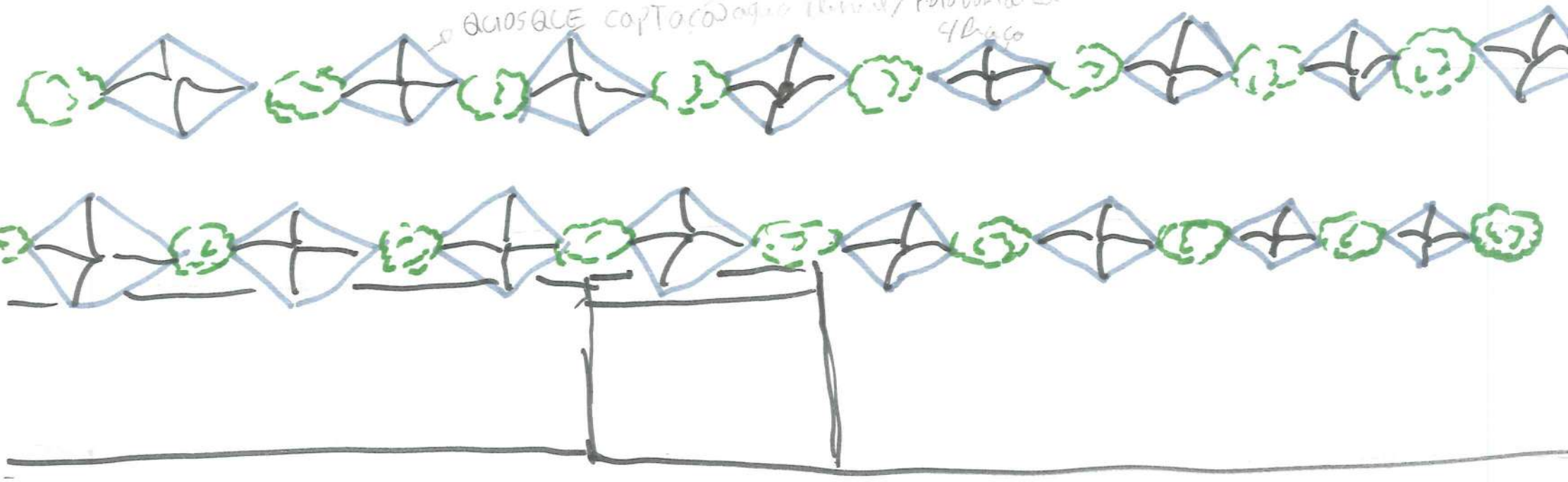

APPROVA 0

PLANO DIR F TOR

PL 17 49 / 15

PL 17 50 / 15







LUZ PARA PESSOAS

Cidade Verde.





+ Mais face las

Yonko  
Kafu

CITE BRAZIL





Daqui a vinte anos apresentaria uma cidade sem separações, completamente integrada e com comunidades altas construía muratos, com espaços de cultura, lazer, alimentação.

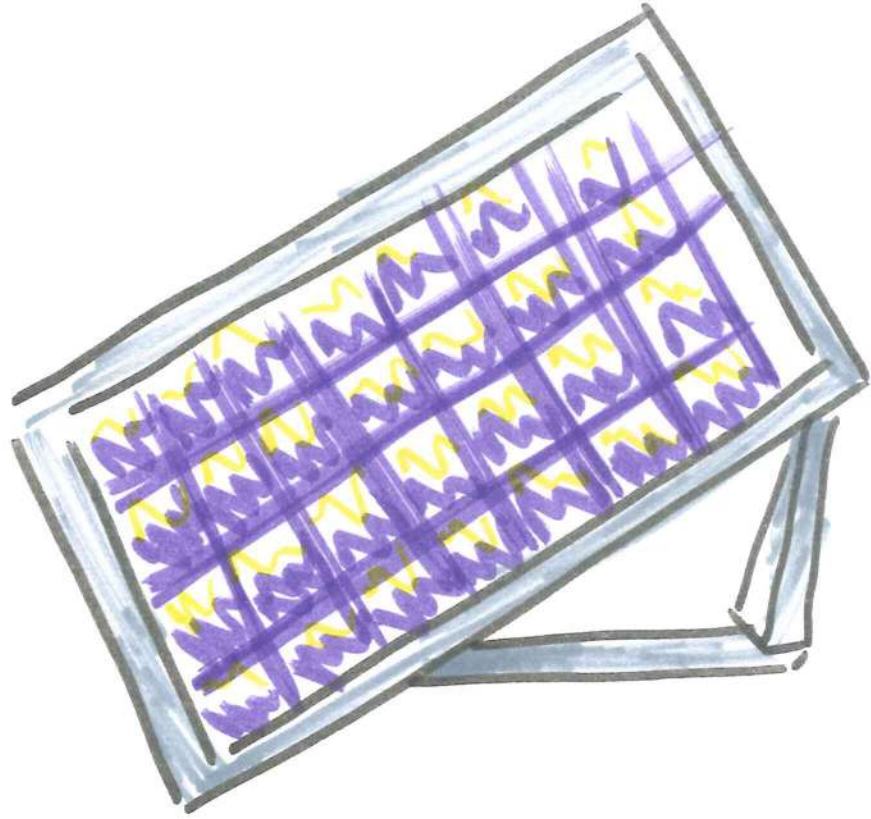
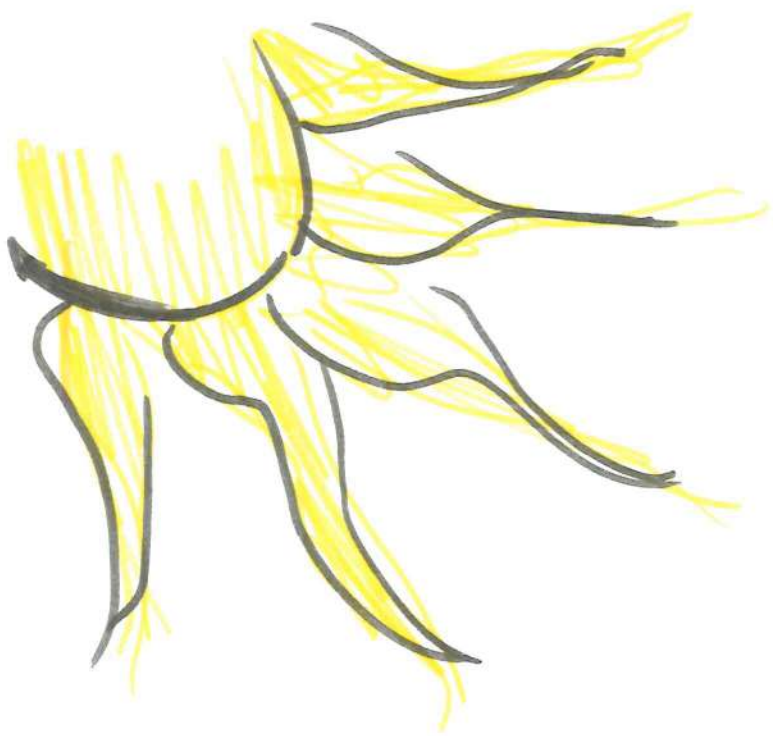

Amara's Sols  
vos que ois  
do tempo

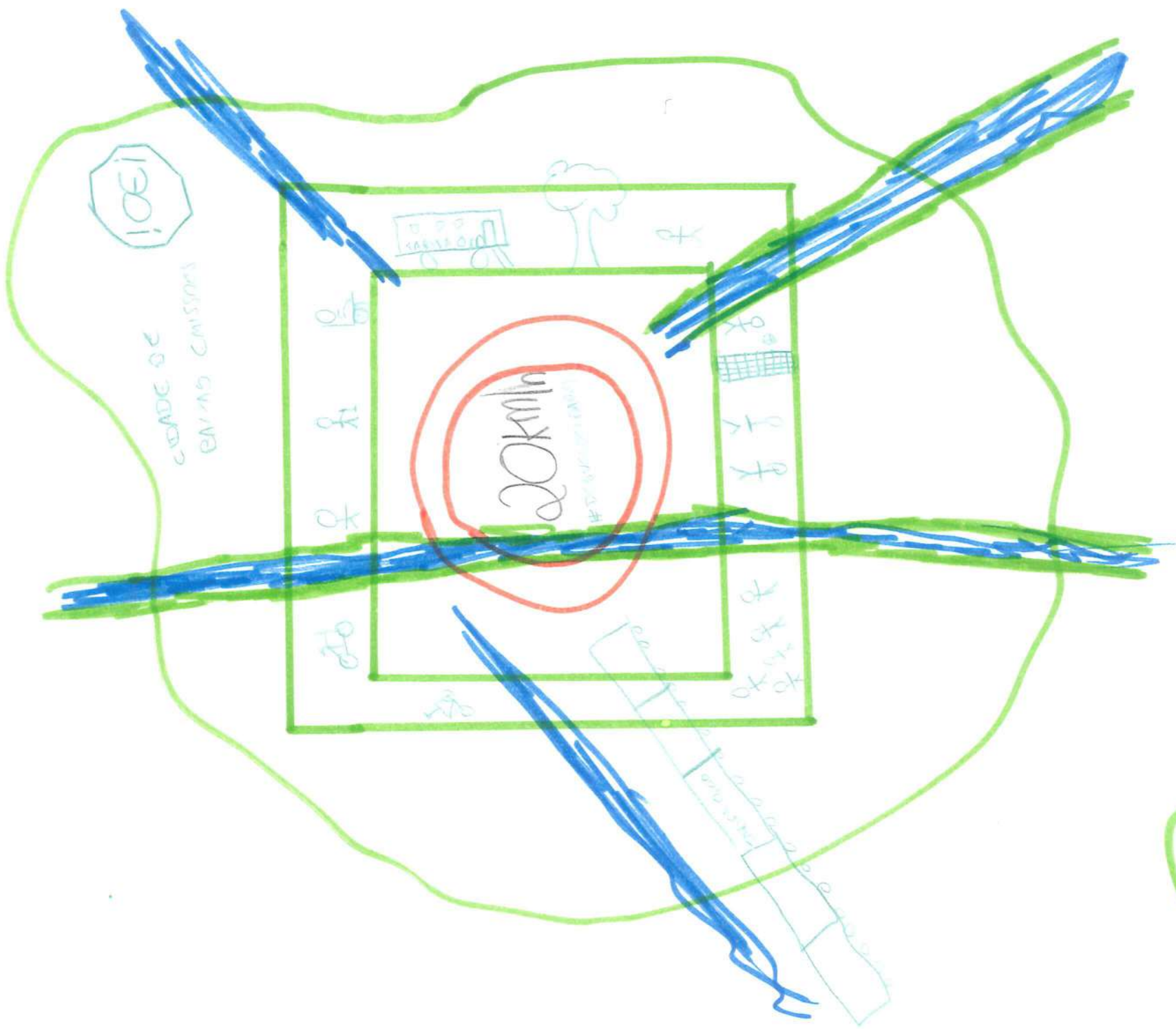

1001

GRADE 02  
EN/MS CUSTOMS

2020  
#2020

#

K:05 AB ERLOS





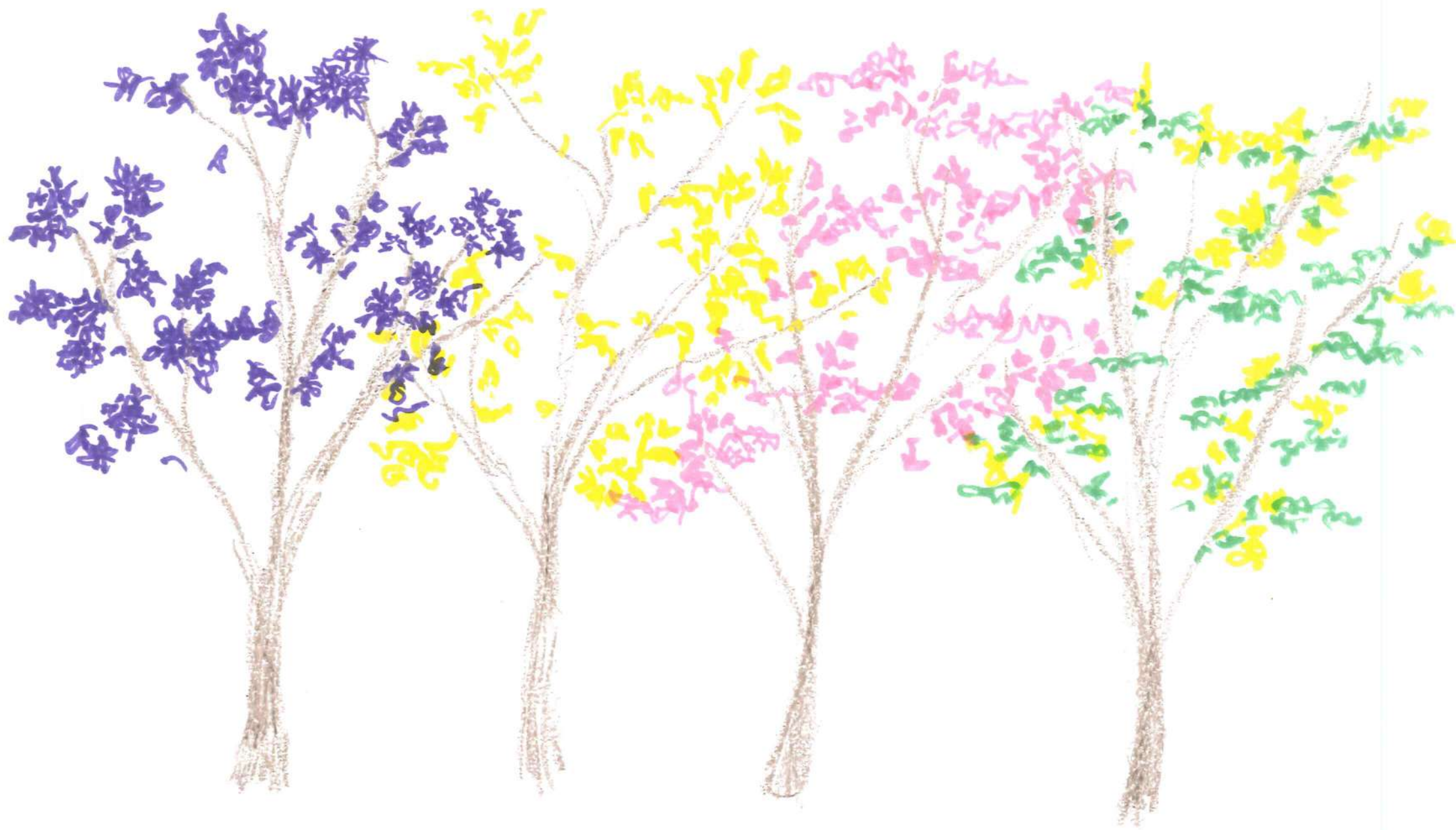

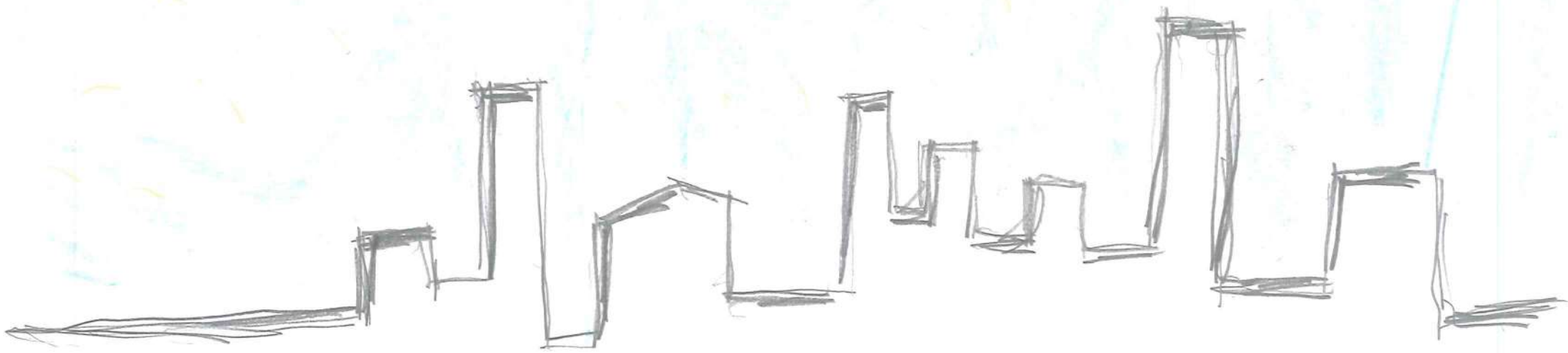

NÃO É, MAS PODERIA SER UM PATRIMÔNIO ; O LÉU  
DIURNO E NOTURNO

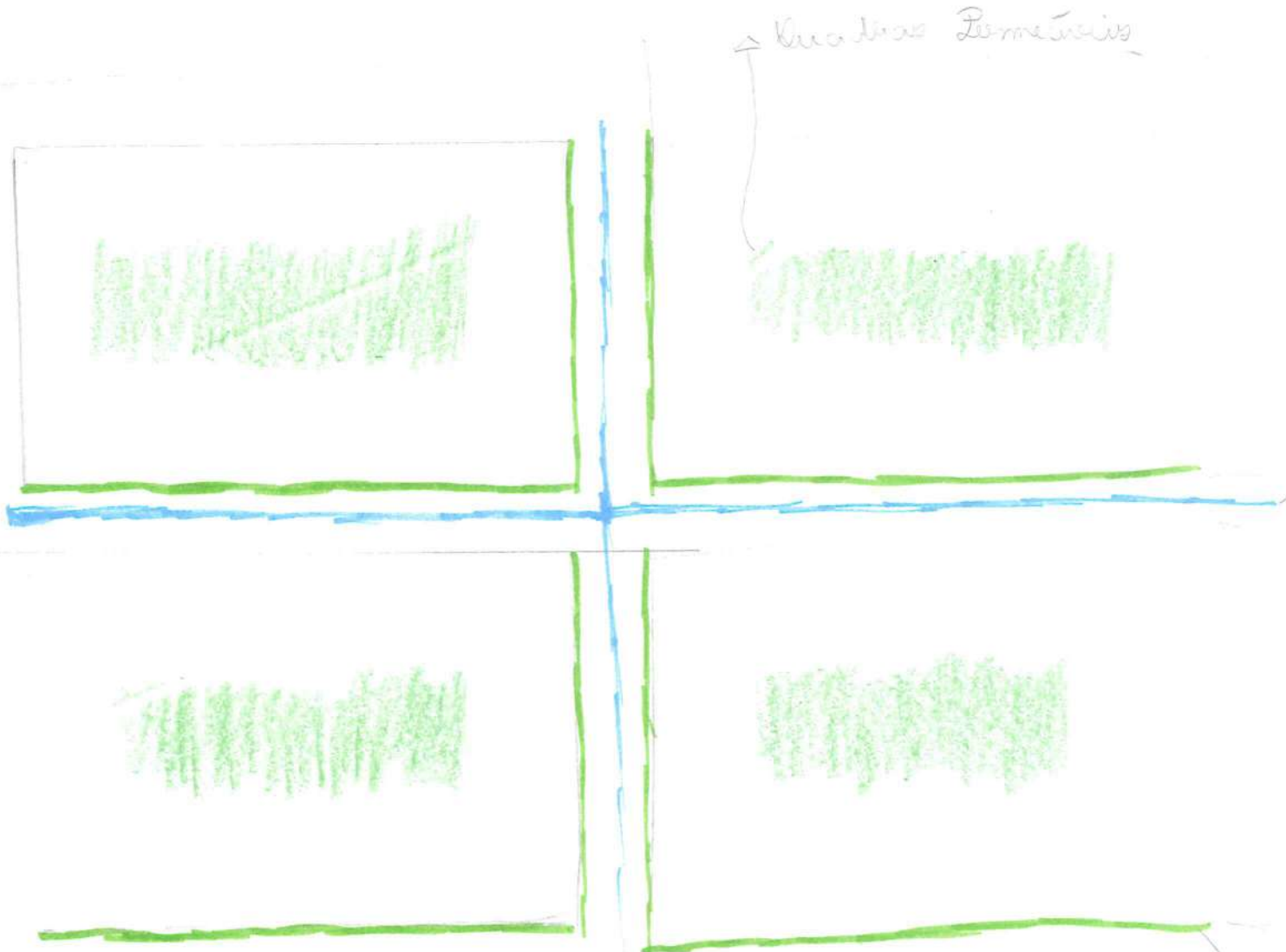

Quadrado Permeável

Atenuação de enxurradas

Simplificação de fendas de relevo mais acentuadas

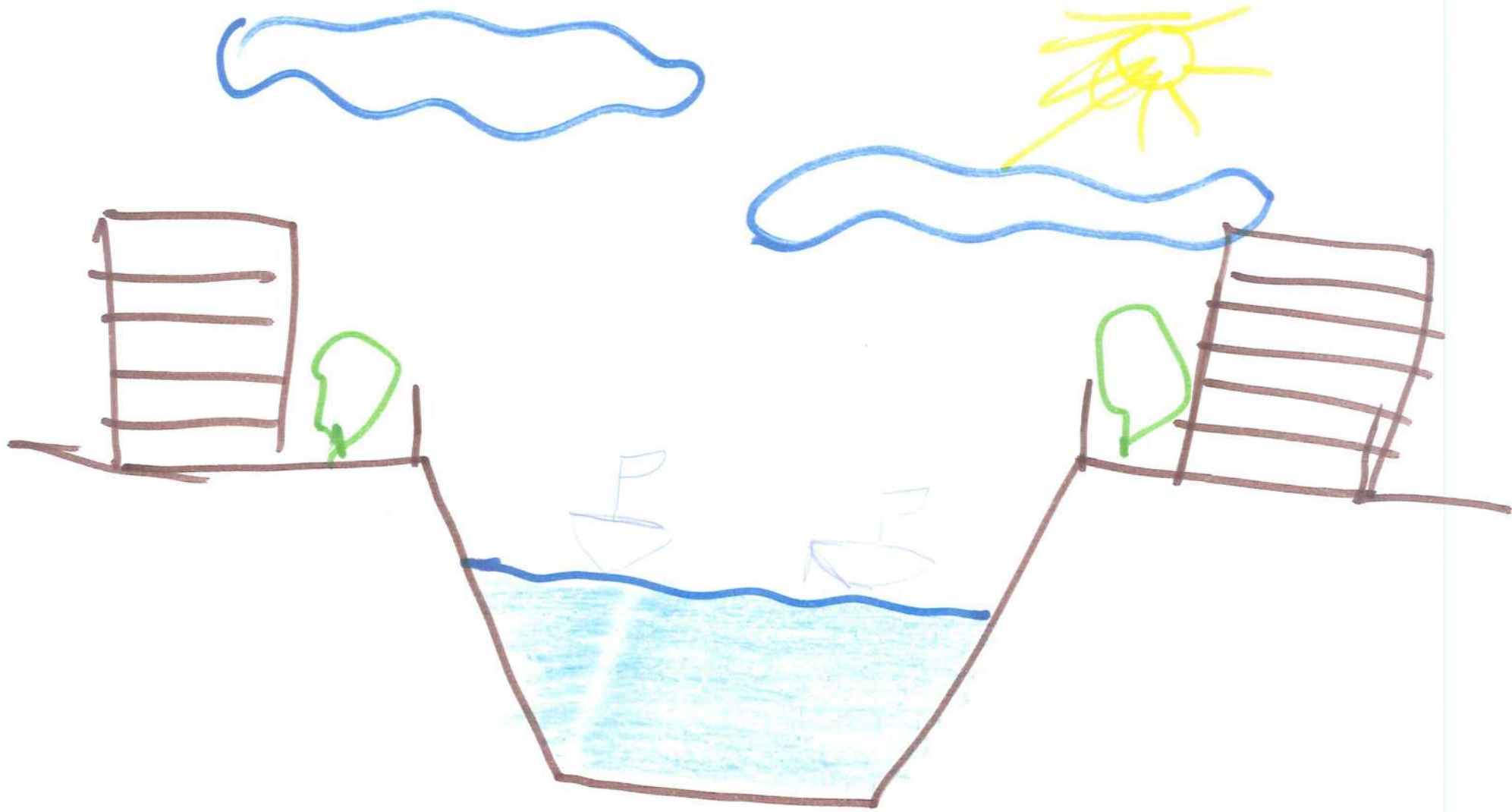

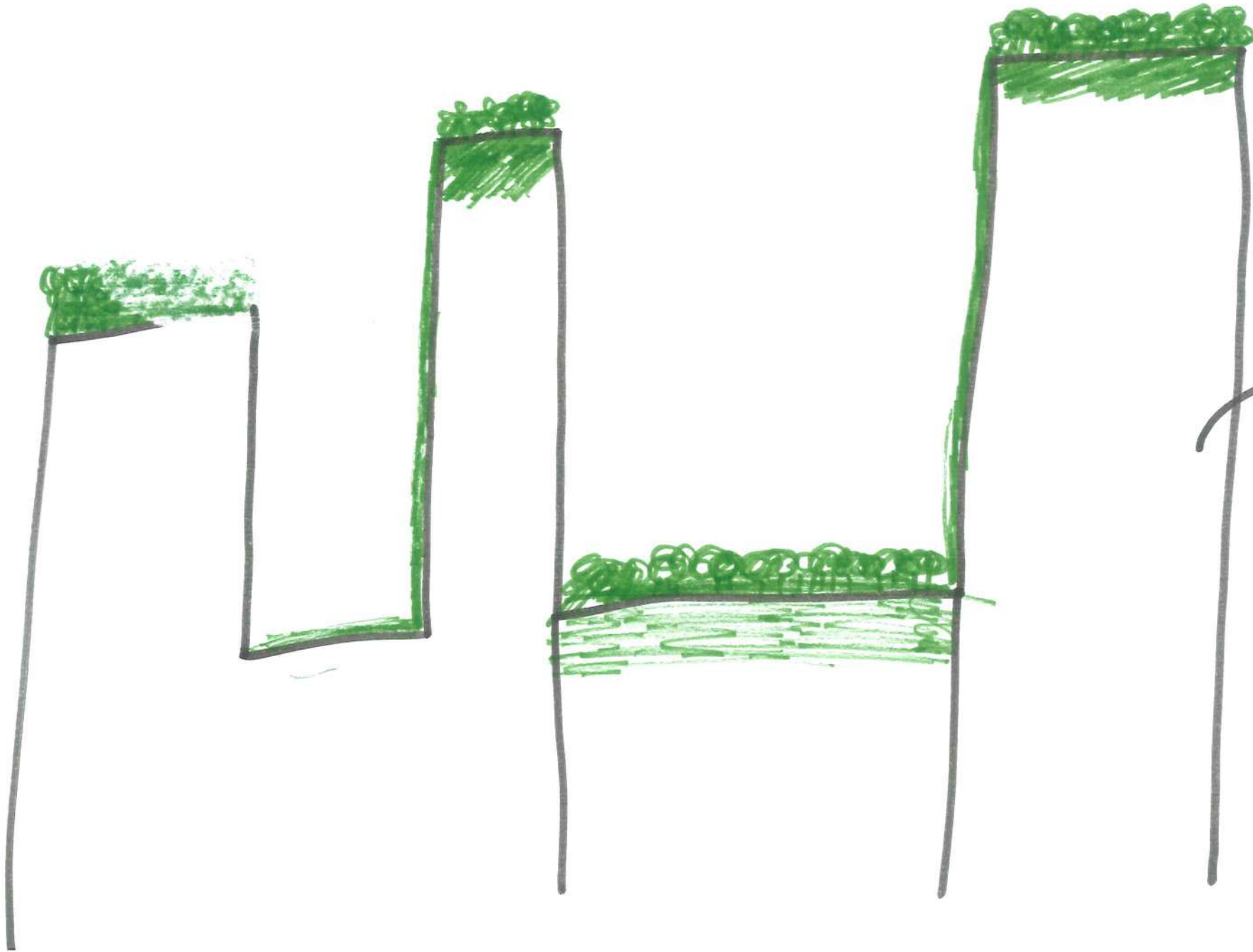

BLANCO



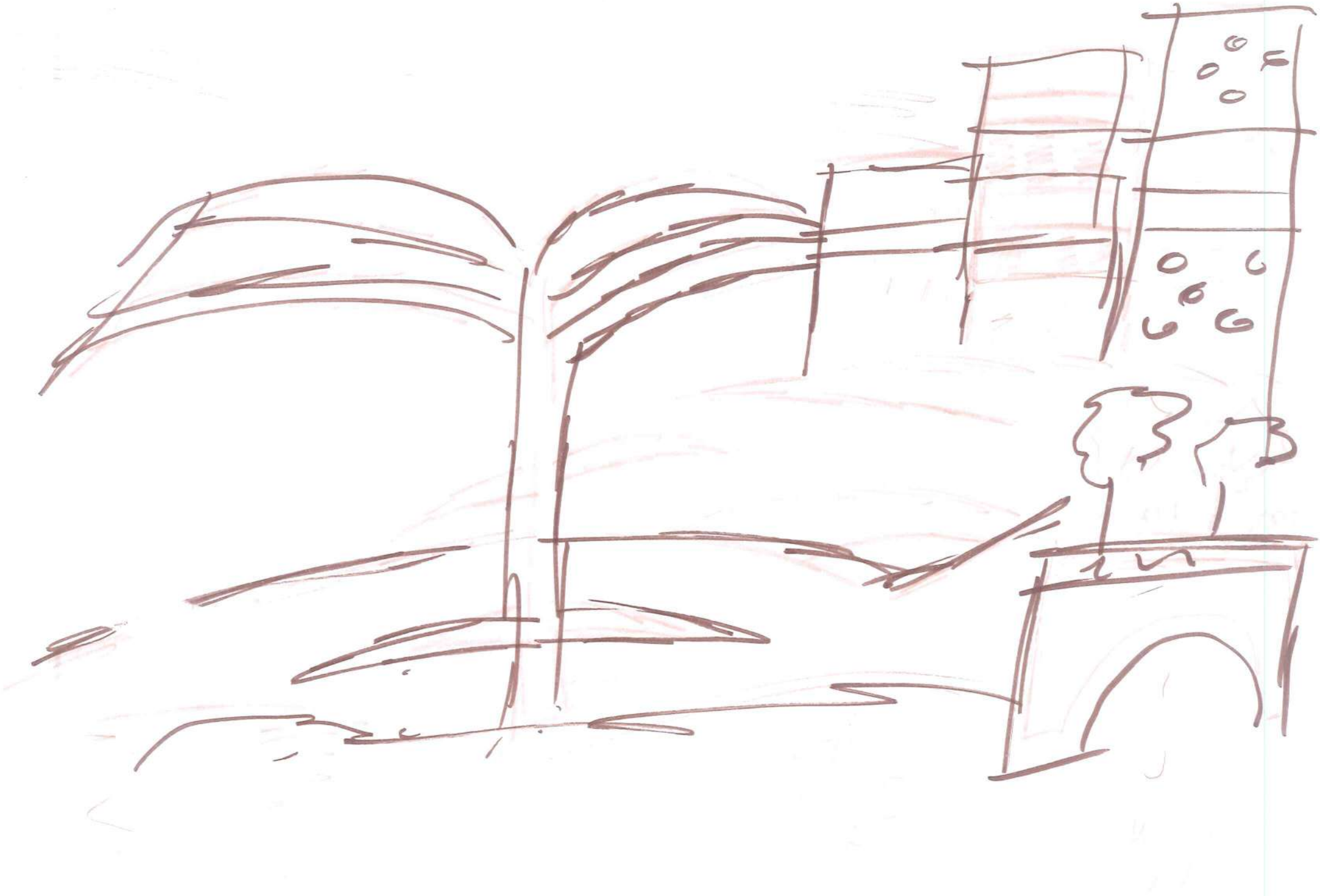

CONSCIENTIZAÇÃO

MANTER AS FERMS  
DE ARTESANATO

II II II II II

II II II II II



Destampar os rios  
& córregos

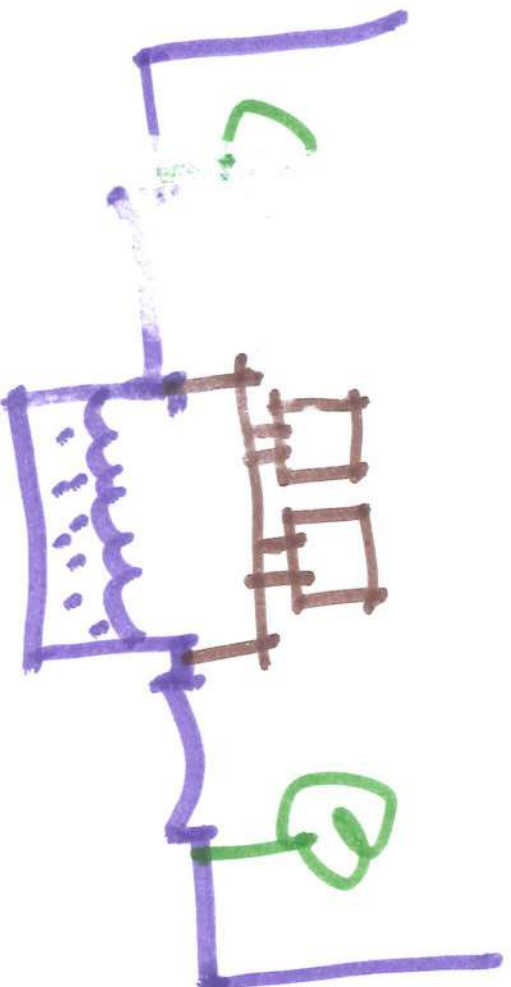
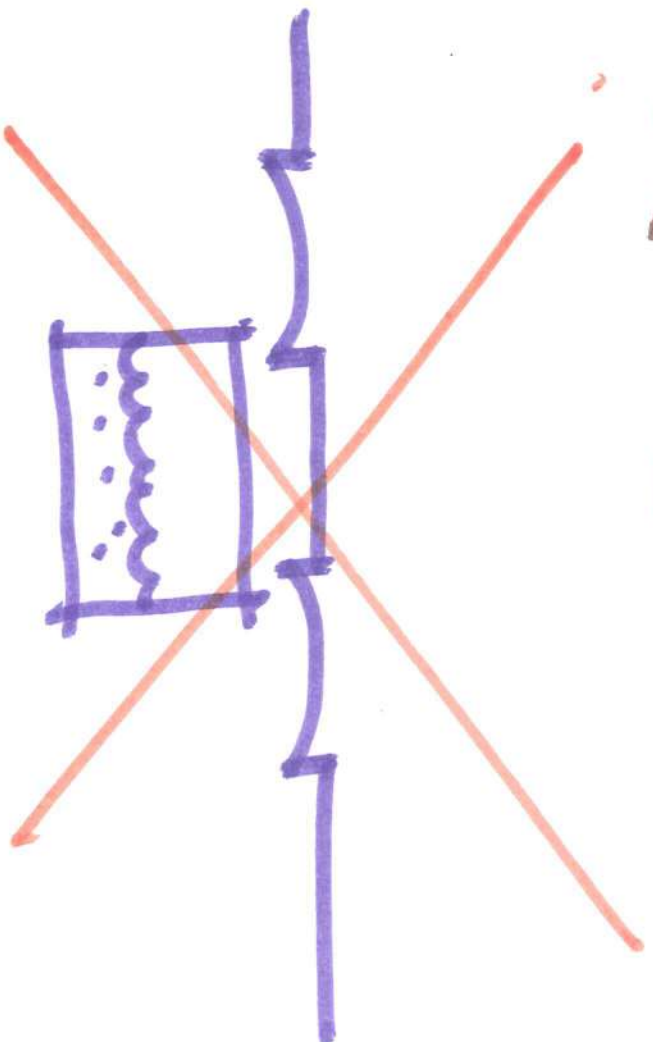

colocar VLT sobre os  
rios a céu aberto



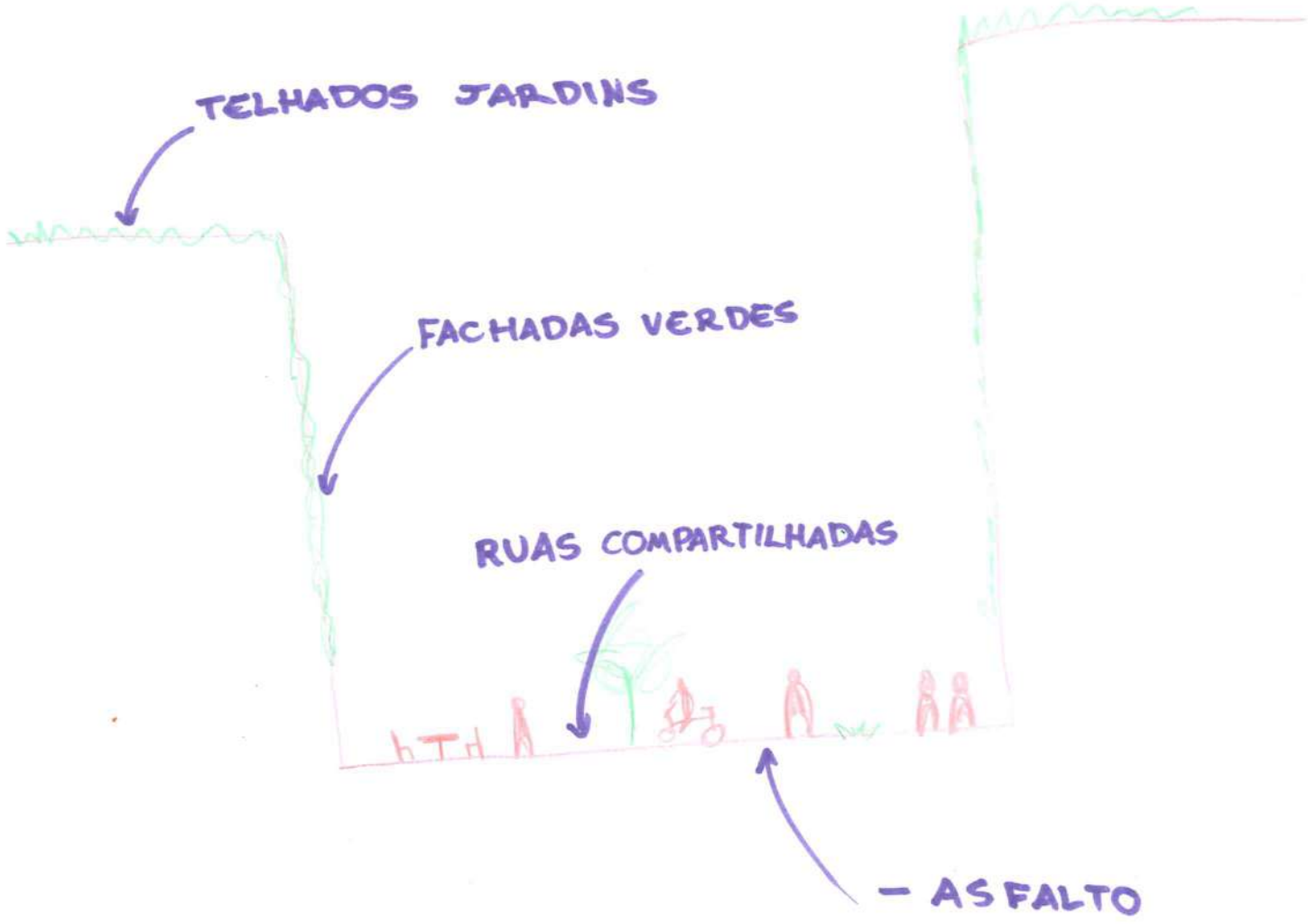

TELHADOS JARDINS

FACHADAS VERDES

RUAS COMPARTILHADAS

- ASFALTO

# Jardim Botânico



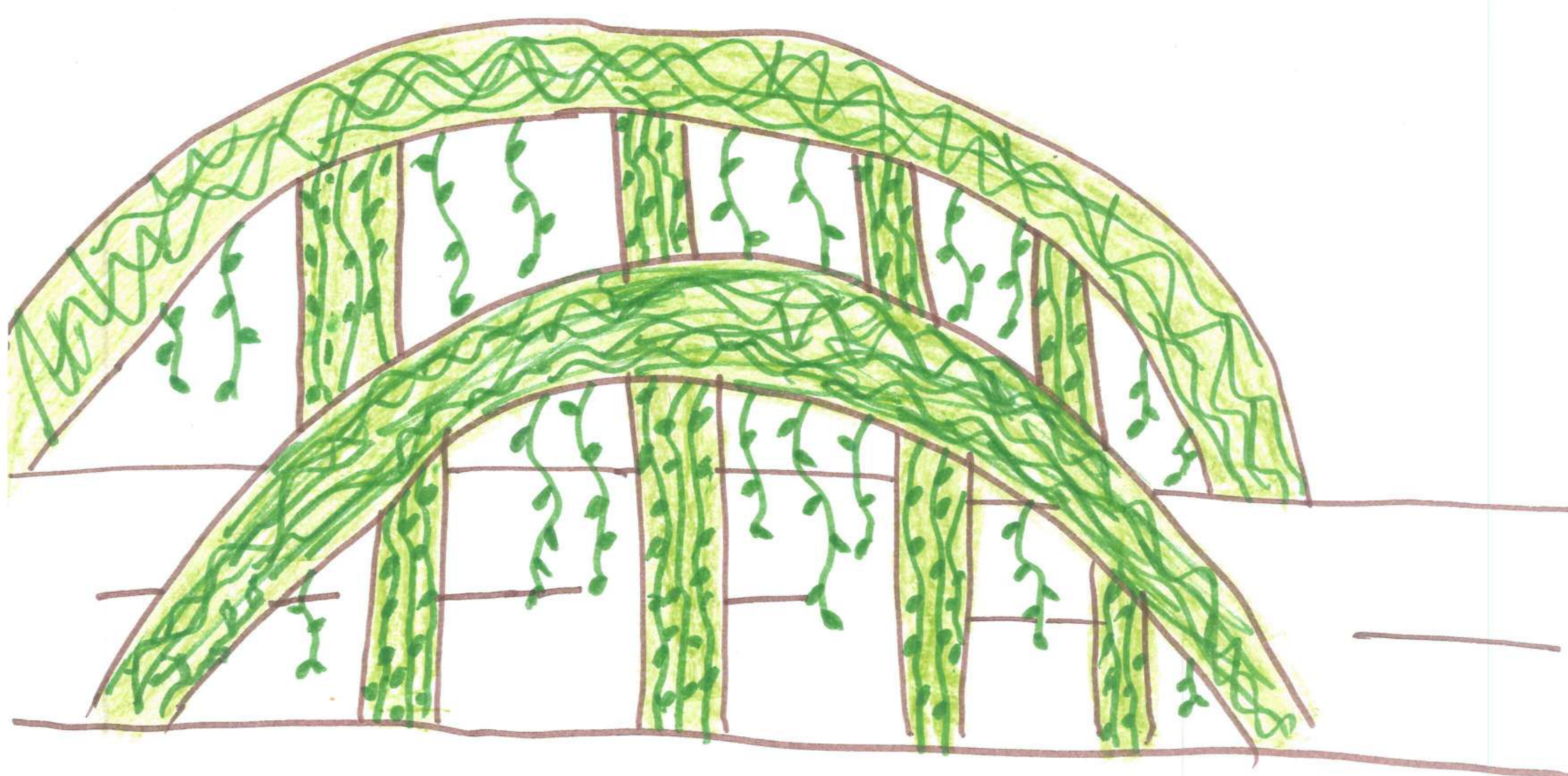

VIADUTO SANTA  
TEREZA COBERTO  
DE TREPadeiras

JÉSSICA

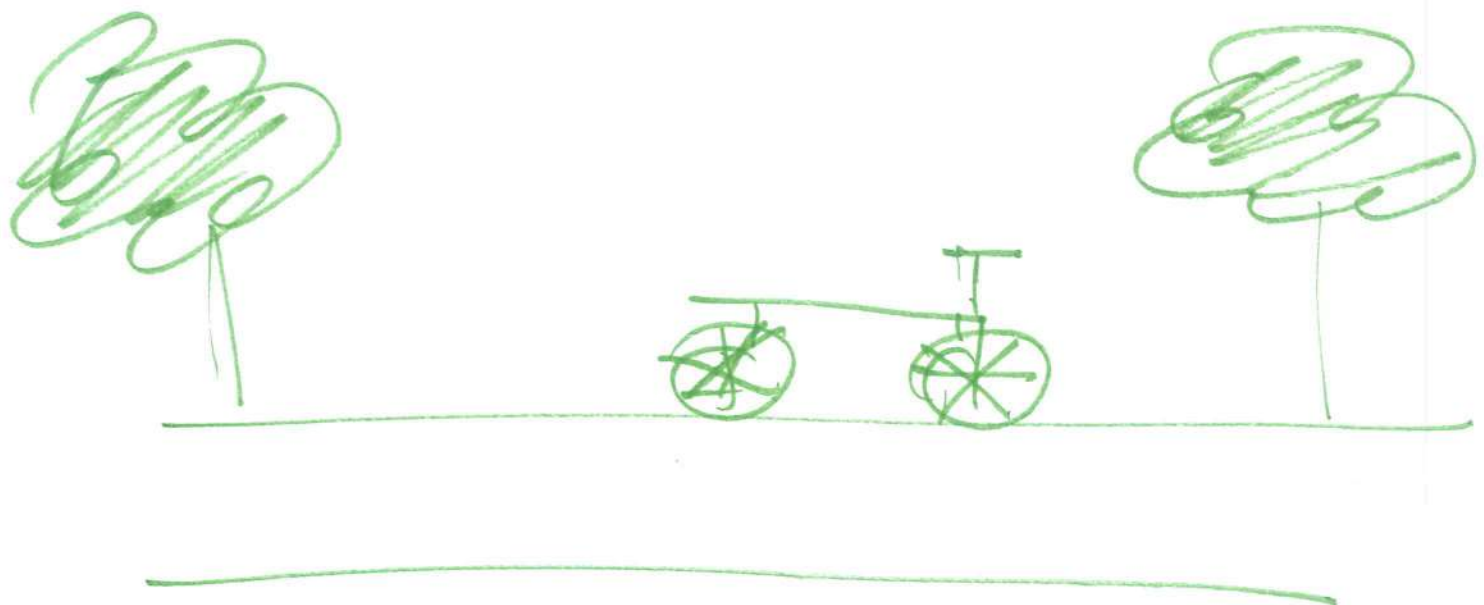

+ CICLOVIA  
+ ÁRVORES

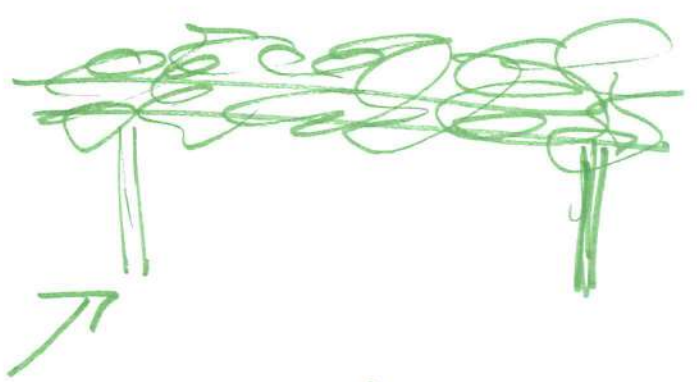

BRANCA  
E CLARA



PERGOLADO NA  
PRAÇA RIO BRANCO

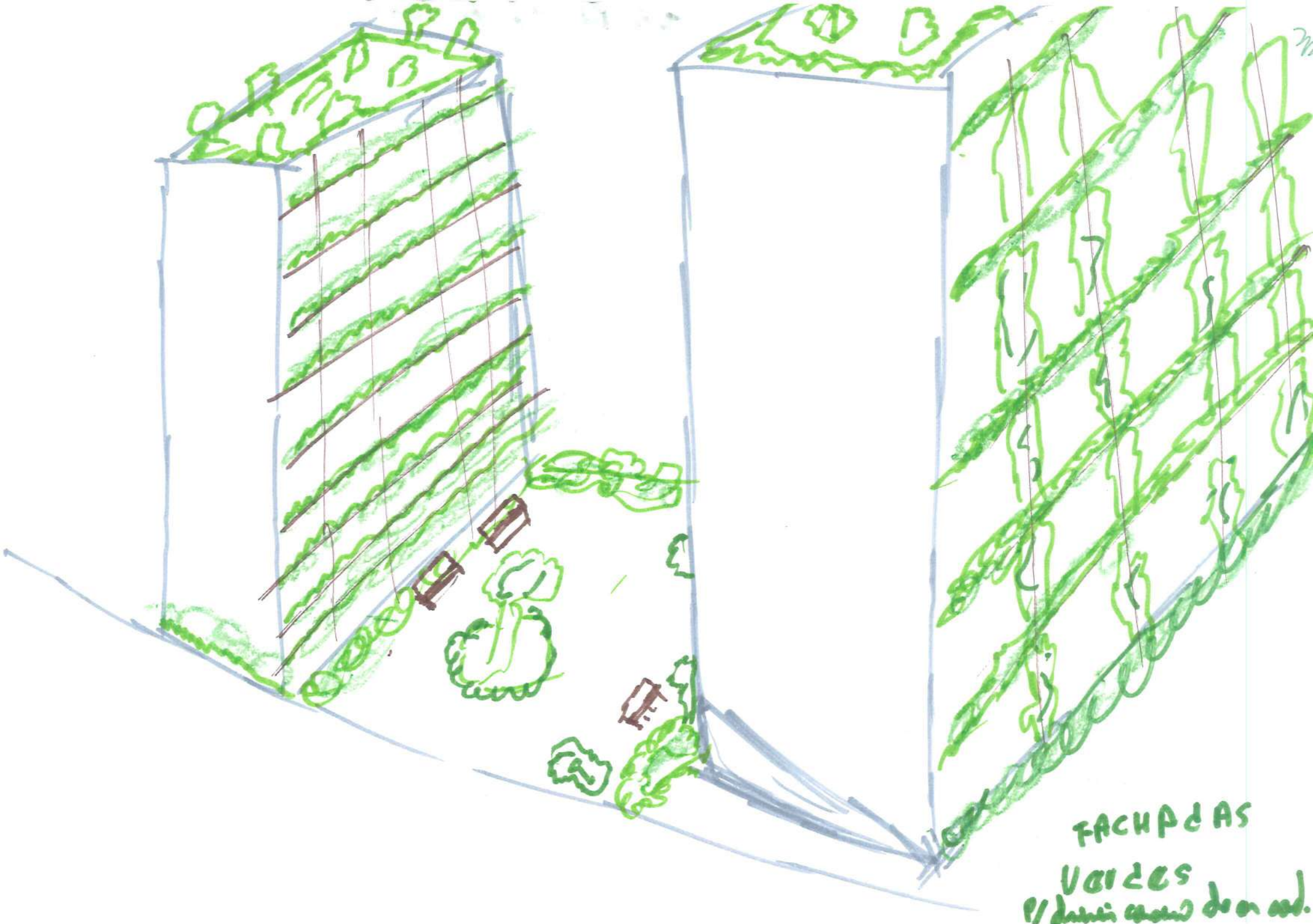

FACHADAS  
VERDES  
P/ dentro e fora do ar. cad.

RETROFIT DE  
EDIFÍCIOS SUBUTILIZADOS

Ocupação DE  
VAZIOS

TERRAÇOS -  
- JARDIM

MELHORES  
CONDIÇÕES  
- PARA  
CULTIVAR

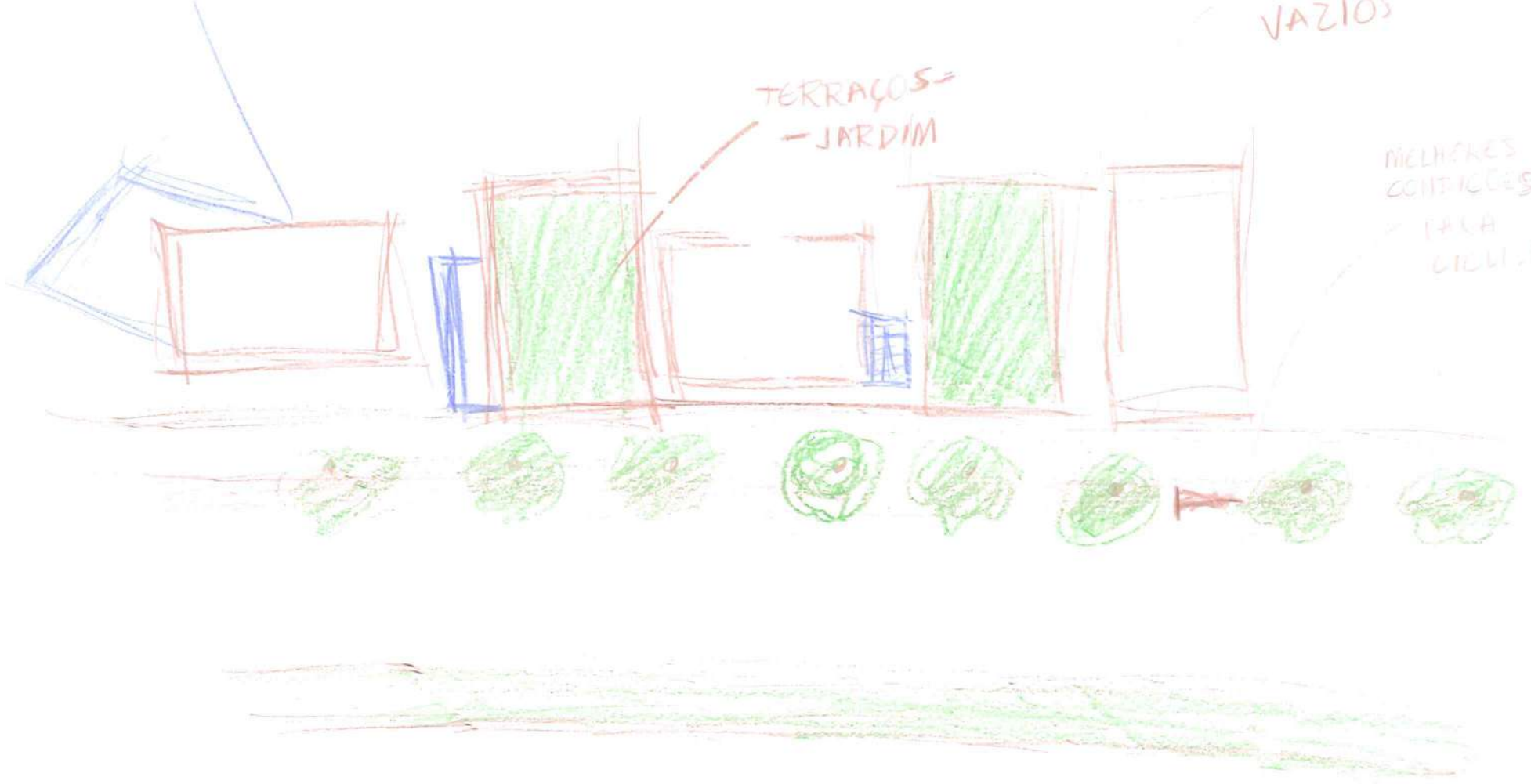



CORREDORES

ECOLOGICOS

METROPOLITANAS

BH

PARQUE

PARQUE  
LINEAR

RIO DAS  
VALHAS  
MARGINAL

CIRCUITO DE  
SERZAS

BH CIDADE JARDIM



DESIGNCAIXOTAMENTO  
CORREÇÔES E  
PROPOSTAS

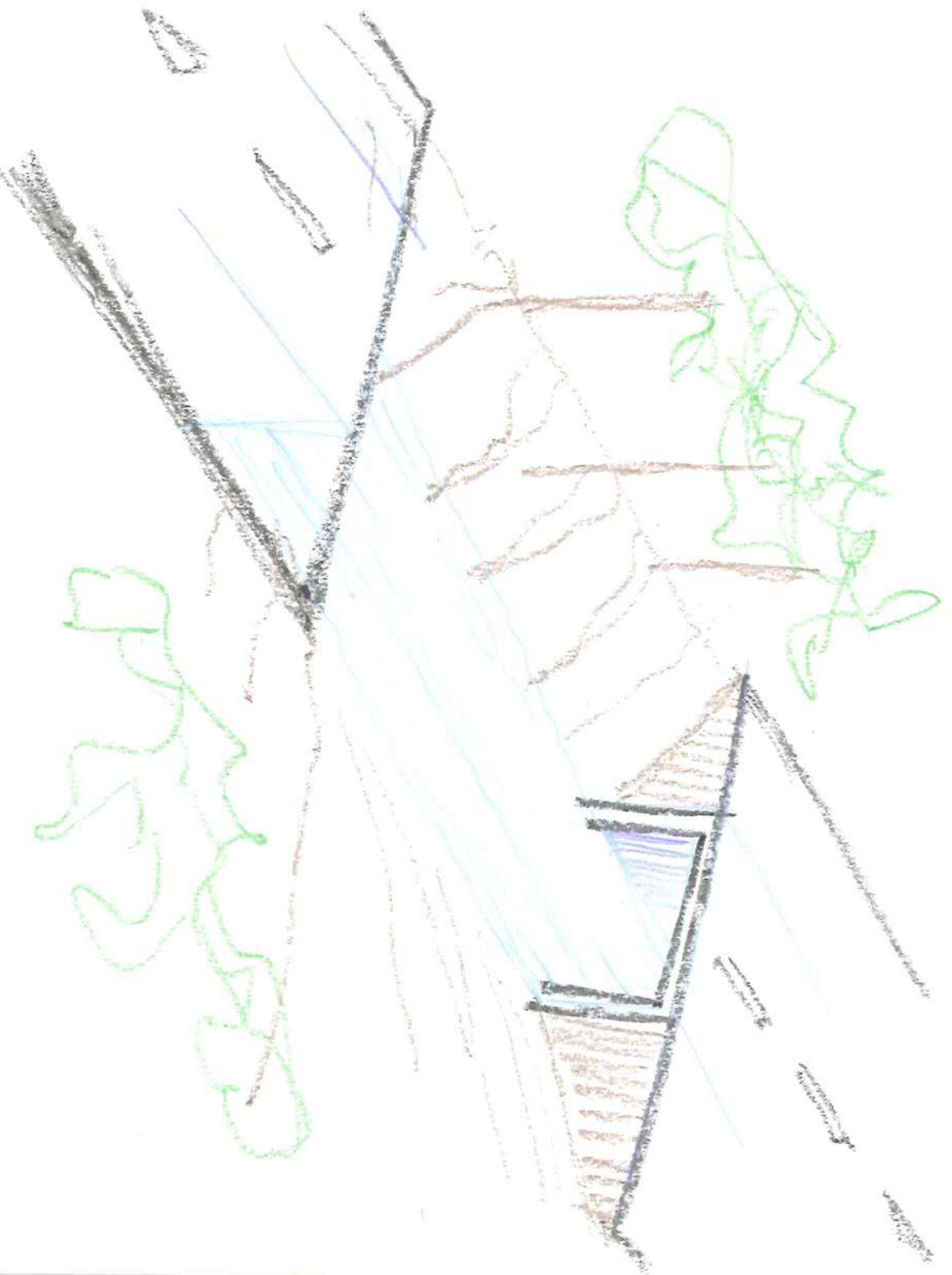

PROPOSTA

Wanda Kausel

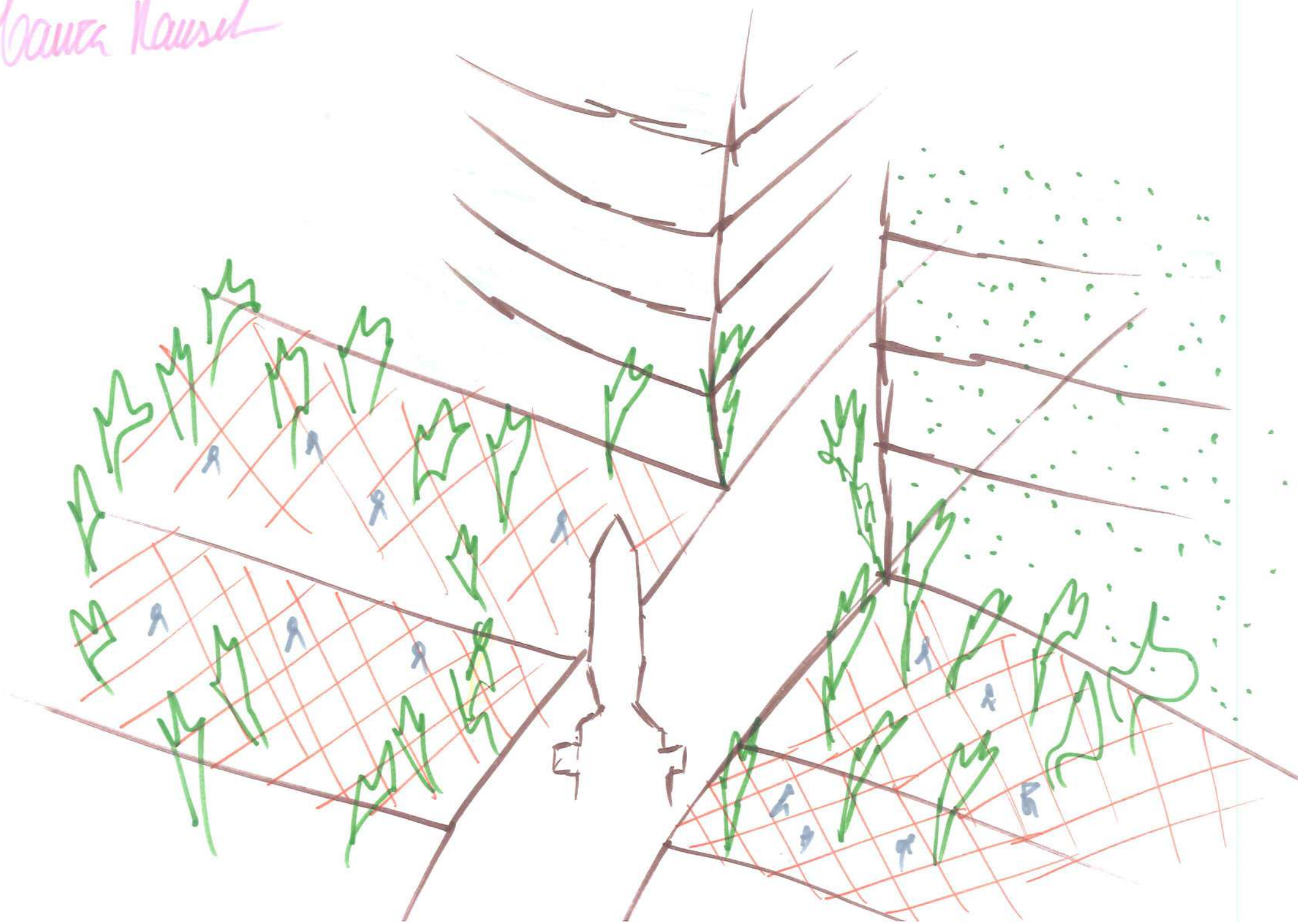

# ILUMINAÇÃO PÚBLICA COM PLACAS DE ENERGIA SOLAR



PLANTAS  
FOTOLUCIFERAS  
PARA ILUMINACIÓN  
PÚBLICA

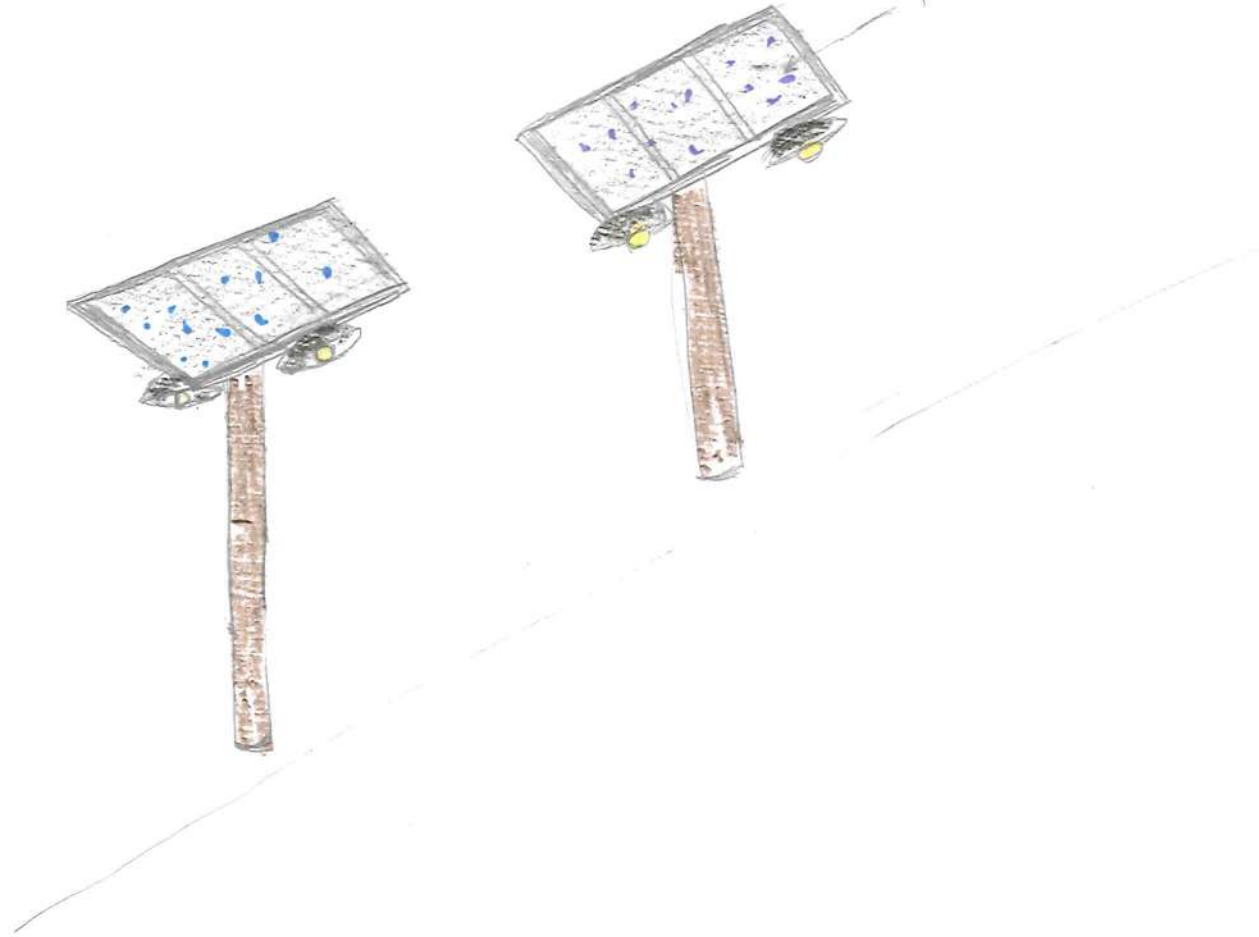

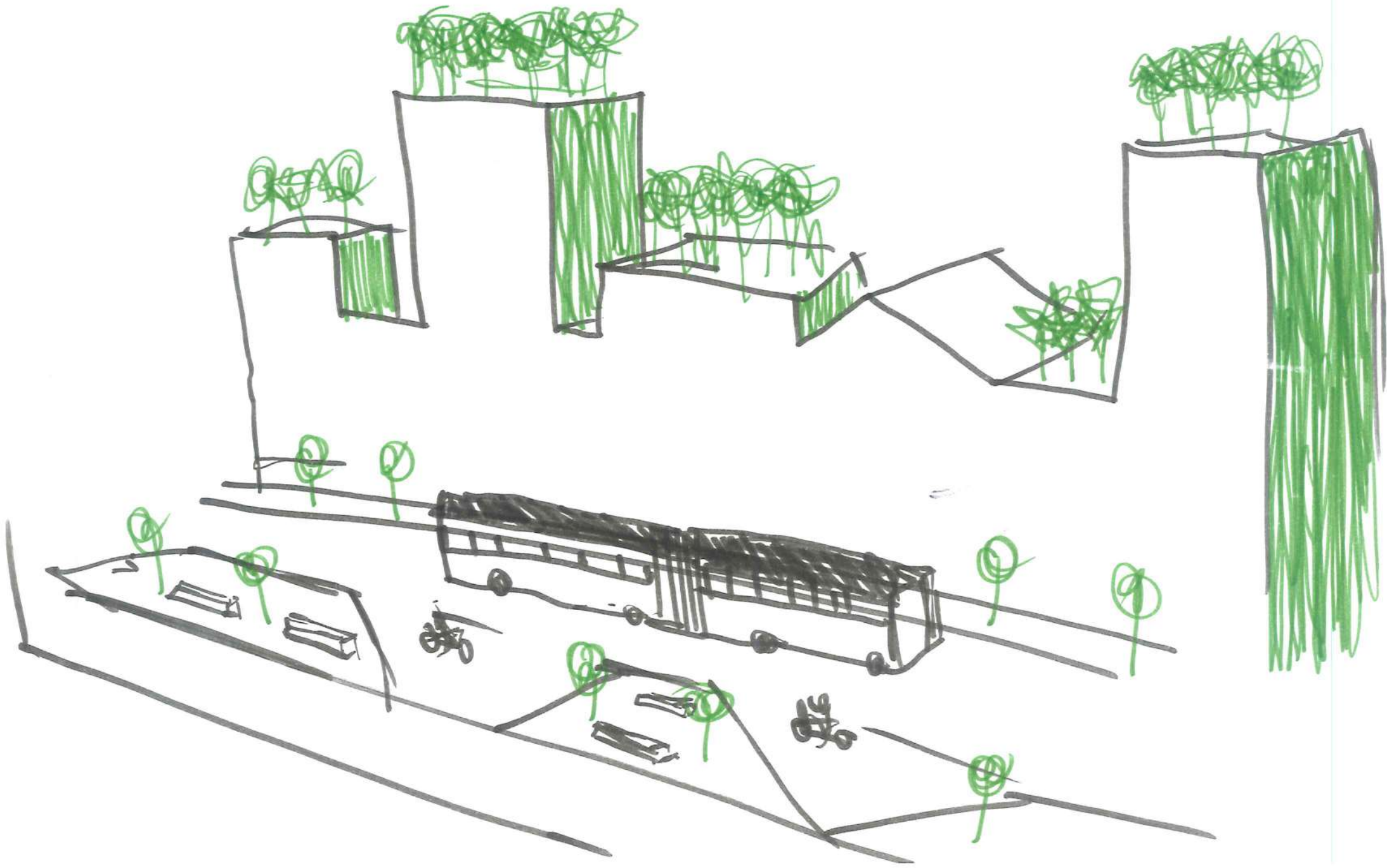

# PRACA PARA A GENTE

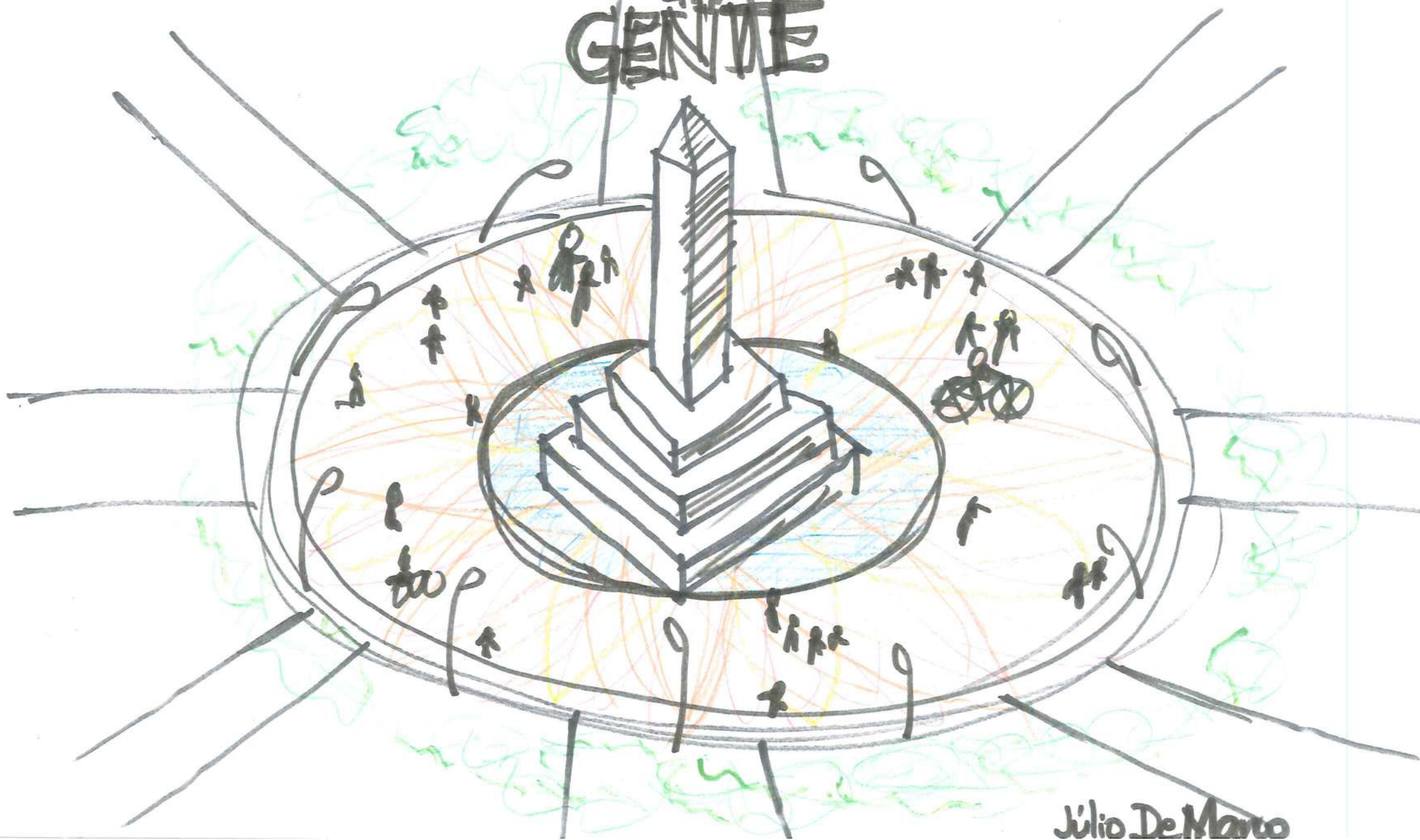

Júlio De Marco



BH VERDE  
NOVAMENTE

Foto: [illegible]

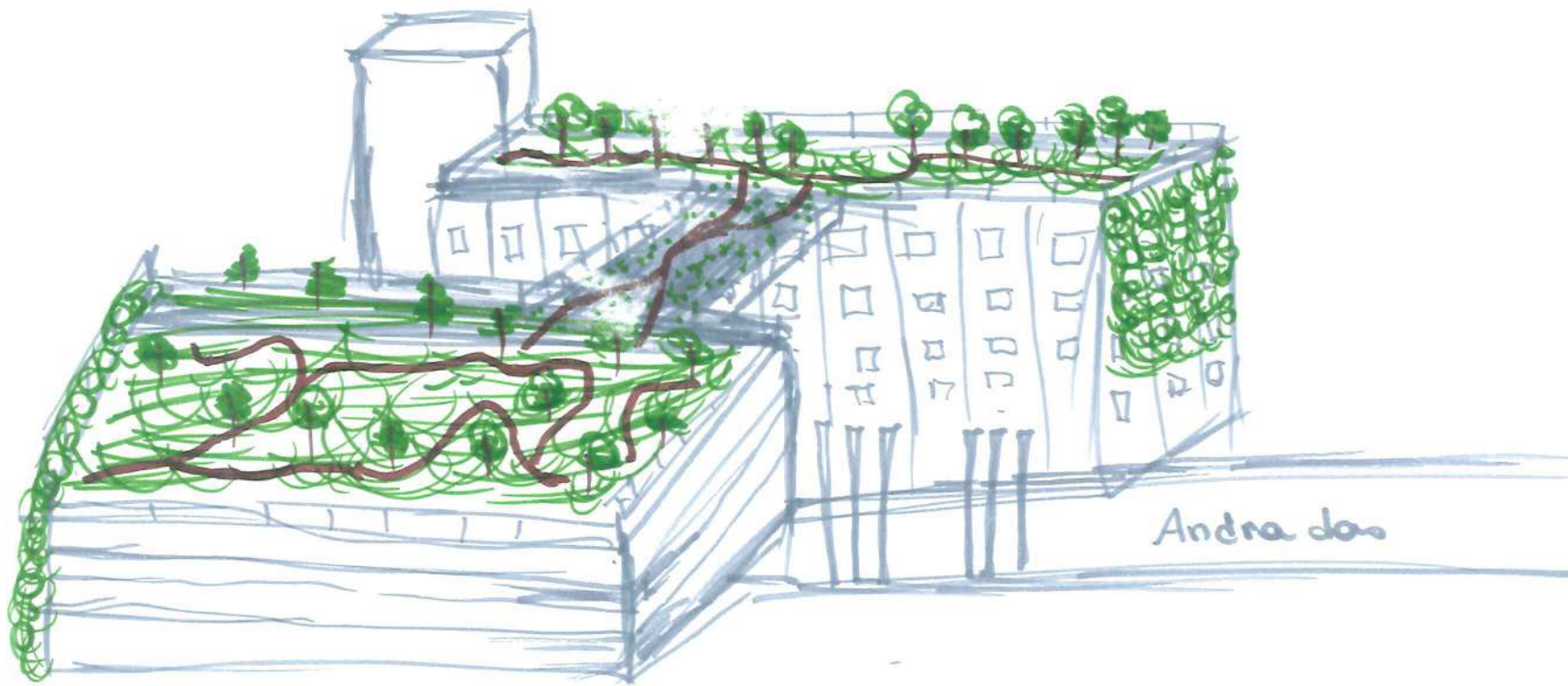

Andra dos

Giseli Santos e  
Isabel Vaz



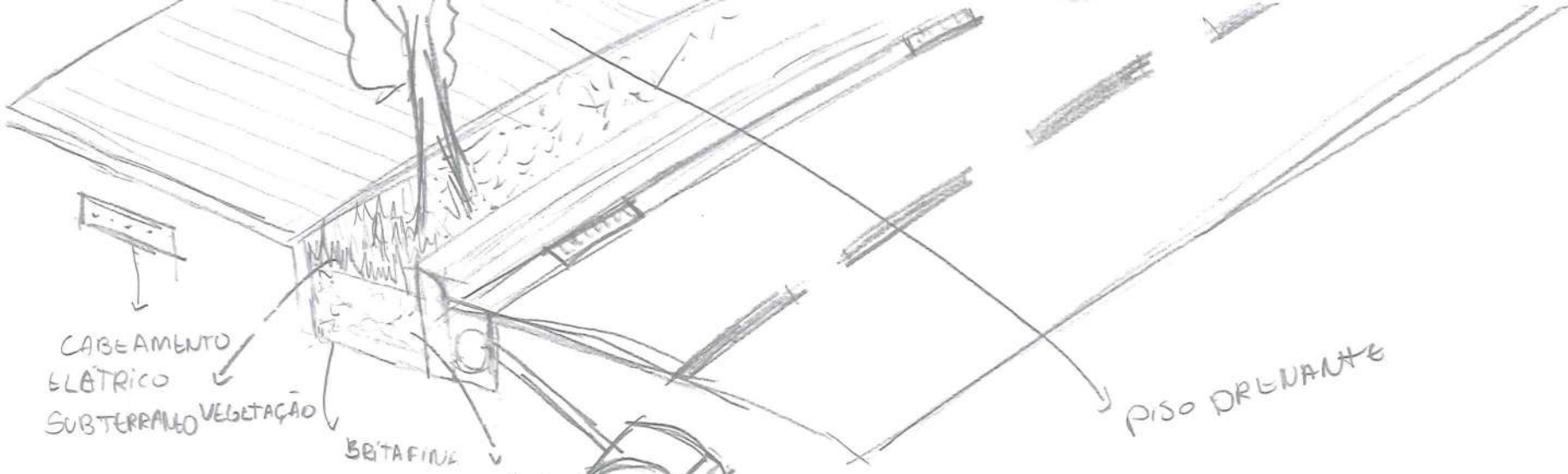

CABEAMENTO ELÉTRICO SUBTERRÂNEO

VEGETAÇÃO

BRITAFINA

BRIT GROSSA

PISO DRENANTE

COLETOR D'ÁGUA PLUVIAL

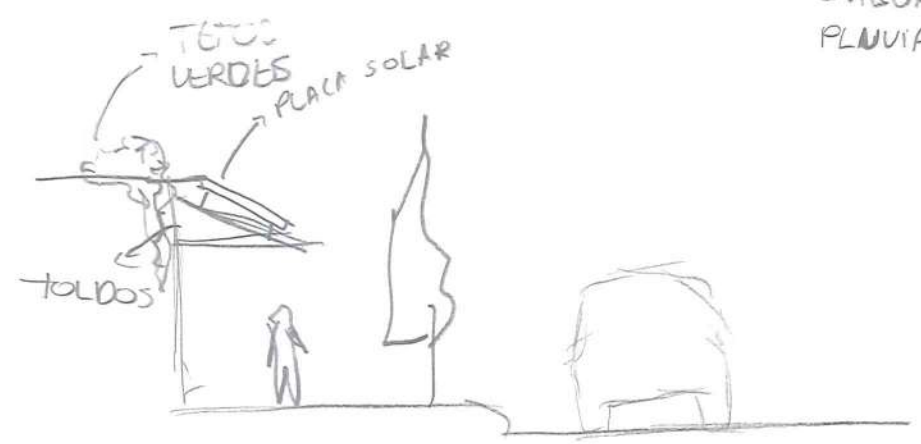

TETO VERDES

PLACA SOLAR

TOLDOS

# SAPUCAÍ SEM PASSEIO UM OLHAR PARA CIDADE



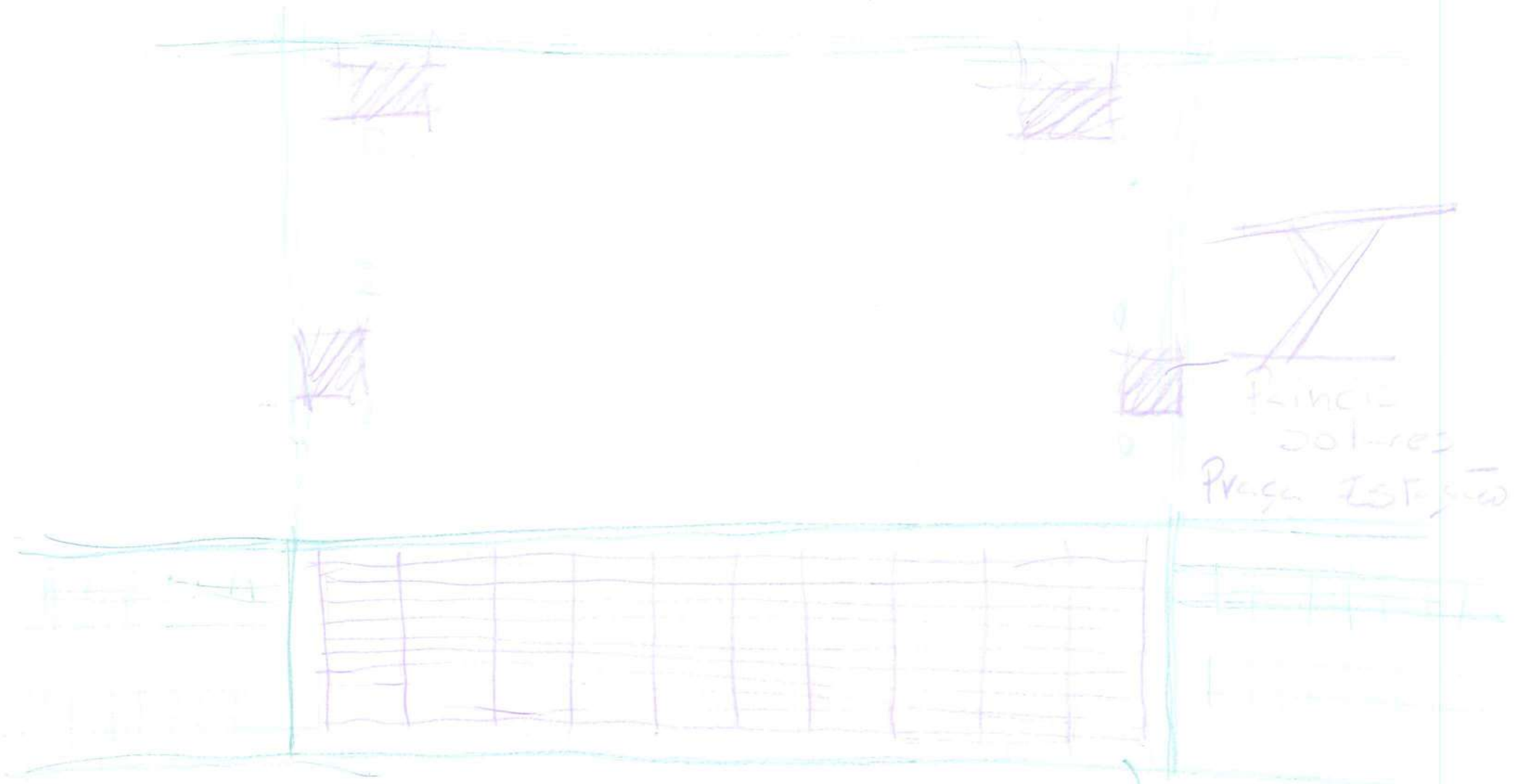

Inicio  
20-1-2012  
Praga EST 500

Medidor de  
Energía Solar

# RIO ARRUDAS COM CHEIRO DE ARRUDA



Pontos Coleta  
Percursos em

Inspiração:  
Estação:  
Dopas em  
Boemia/PA

Espacos  
Kioski  
Aerres

Artes  
Exposicoes

Bandas  
Pesquiso e  
Comerça

Gazebos  
e Comidas  
Típicas  
Artesanatos  
Música

BOULEVARD  
ARRUDAS  
Pontas  
Região

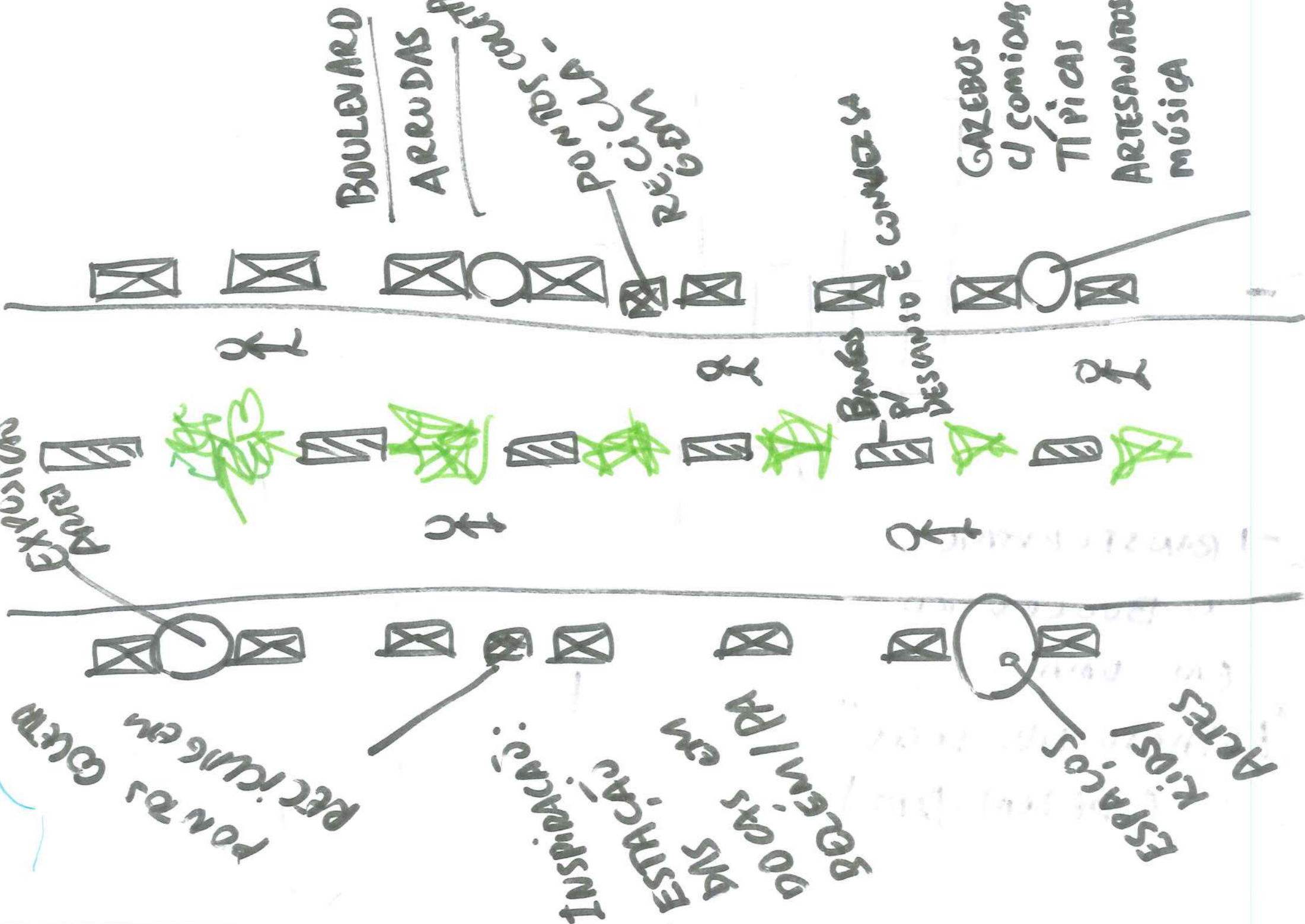



MARCOY.